

## DETAILS

<b>Product Number</b>	CA14461_VERONICA-SQ-M
<b>Family</b>	Veronica
<b>Type</b>	Assembly
<b>Color</b>	clear
<b>Diameter</b>	22,5x22,5 mm
<b>Height</b>	12,2 mm
<b>Style</b>	square
<b>Optic Material</b>	PMMA
<b>Holder Material</b>	
<b>Fastening</b>	tape, pin
<b>Status</b>	production ready
<b>ROHS Compliant</b>	Yes
<b>Date Updated</b>	30/11/2016

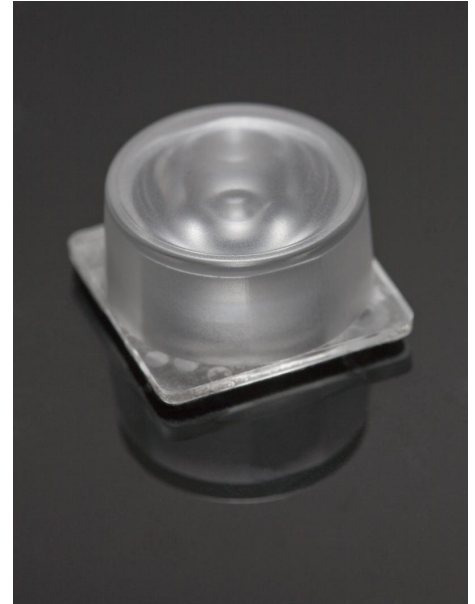

## OPTICAL PROPERTIES

LED	Viewing	Light	Efficiency	cd/lm	Connector
	Angle	Beam			
XT-E	27 deg	Medium	87 %	3.500	-
XP-G2	30 deg	Medium	89 %	3.060	-
XP-L	40 deg	Medium	91 %	2.000	-
XM-L	37 deg	Medium	92 %	2.100	-
XP-E2	25 deg	Medium	94 %	4.200	-
XP-E	28 deg	Medium	93 %	3.600	-
XM-L2	38 deg	Medium	91 %	2.100	-
XB-H	29 deg	Medium	91 %	3.000	-
XHP35 HD	40 deg	Medium	88 %	1.900	-
XHP35 HI	33 deg	Medium	88 %	2.700	-
XP-L2	37 deg	Medium	87 %	2.000	-
H35C1 (LEMWA33)	33 deg	Medium	92 %	2.700	-
LUXEON MZ	32 deg	Medium	93 %	2.700	-
LUXEON R	30 deg	Medium	91 %	3.000	-
LUXEON Rebel	26 deg	Medium	92 %	3.600	-
LUXEON T	30 deg	Medium	93 %	3.000	-
LUXEON TX	30 deg	Medium	92 %	3.200	-
LUXEON Rebel ES	27 deg	Medium	91 %	3.500	-
LUXEON A	30 deg	Medium	91 %	3.000	-
NVSxx19B/NVSxx19C	30 deg	Medium	91 %	2.900	-
NCSxx19B	23 deg	Medium	92 %	4.100	-
NWSx229A	39 deg	Medium	89 %	2.000	-
Oslon Square PC	29 deg	Medium	91 %	3.000	-
Oslon Square EC	28 deg	Medium	91 %	3.400	-
Z8Y22P	29 deg	Medium	88 %	2.900	-



**PRODUCT DATASHEET**  
**Veronica series**  
last update 30/11/2016

## OPTICAL PROPERTIES

LED	Viewing Angle	Light Beam	Effi- ciency	cd/lm	Connector
-----	------------------	---------------	-----------------	-------	-----------

Relative intensity of CA14461\_VERONICA-SQ-M\_(XT-E)

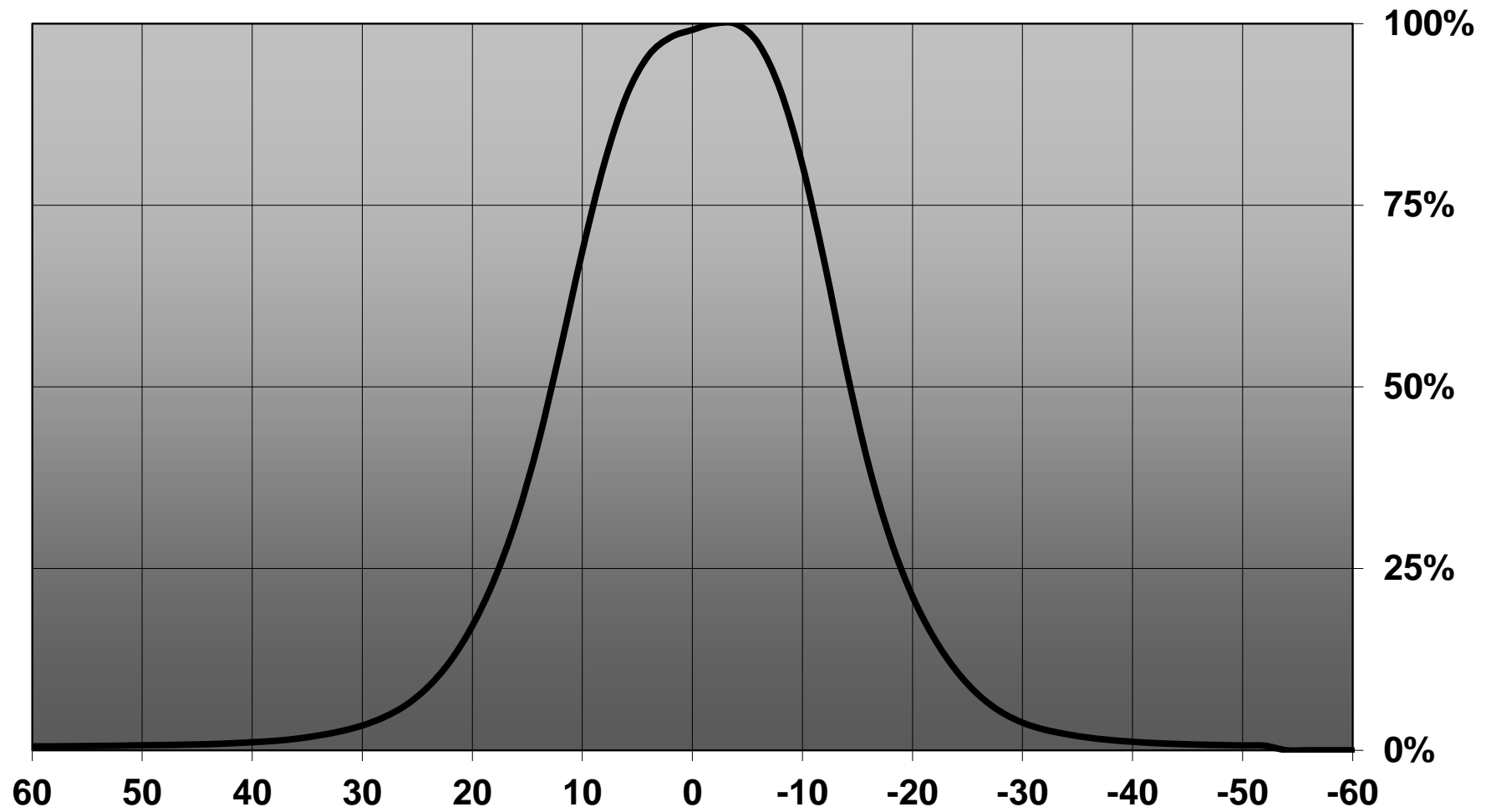

Relative intensity of CA14461\_VERONICA-SQ-M\_(XP-G2)

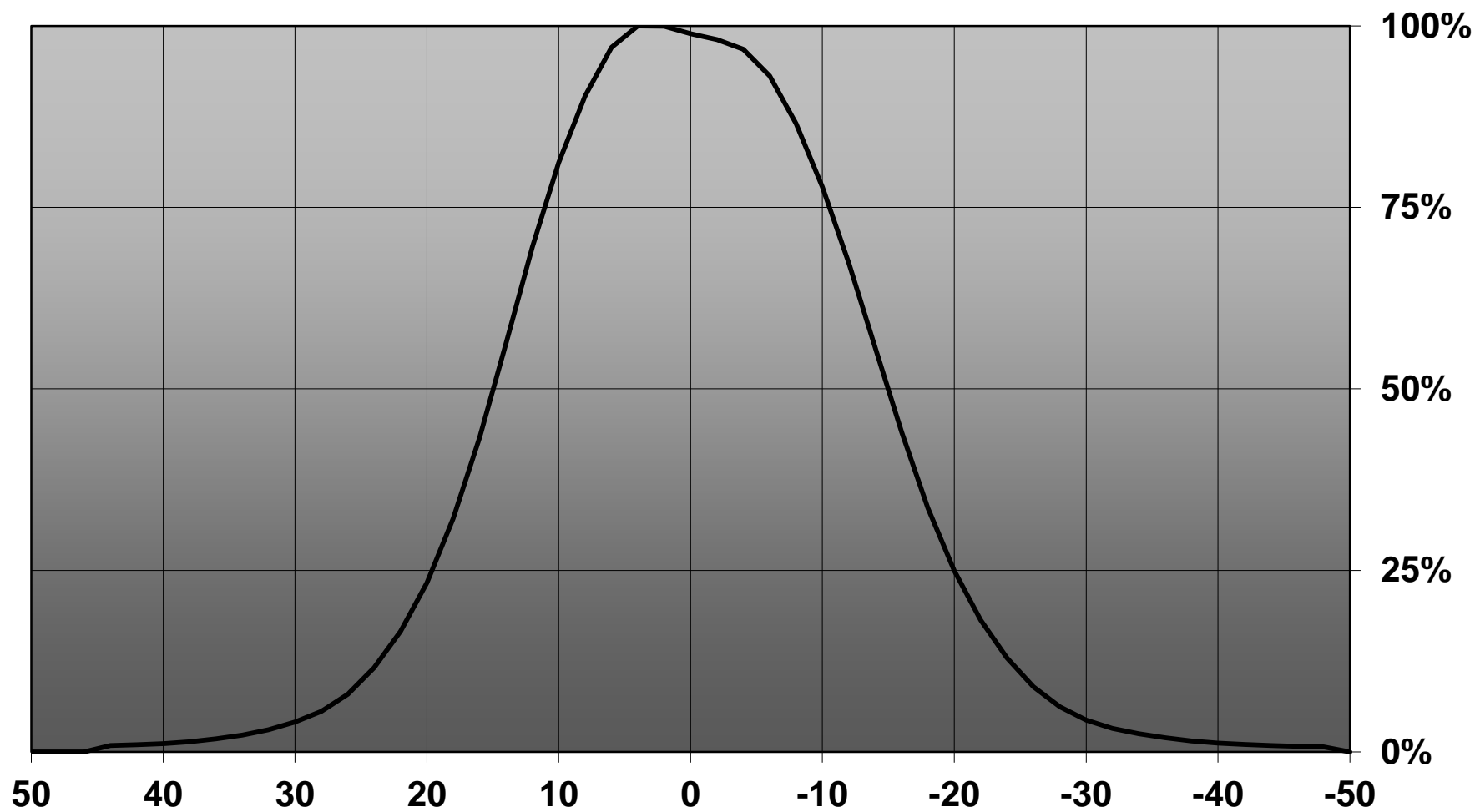

Relative intensity of CA14461\_VERONICA-SQ-M\_(XHP35\_HD)

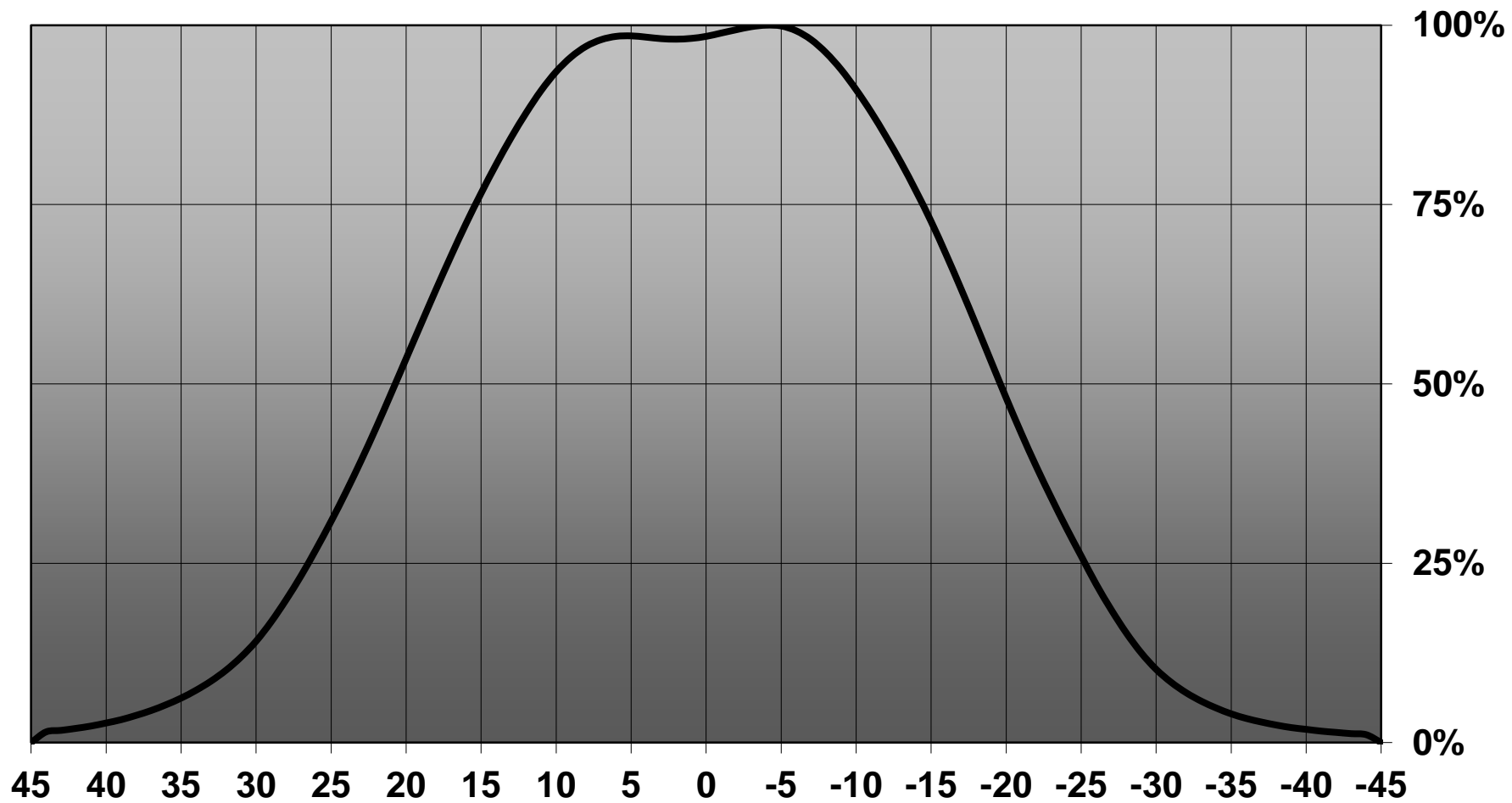

Relative intensity of CA14461\_VERONICA-SQ-M\_(XPH35\_HI)

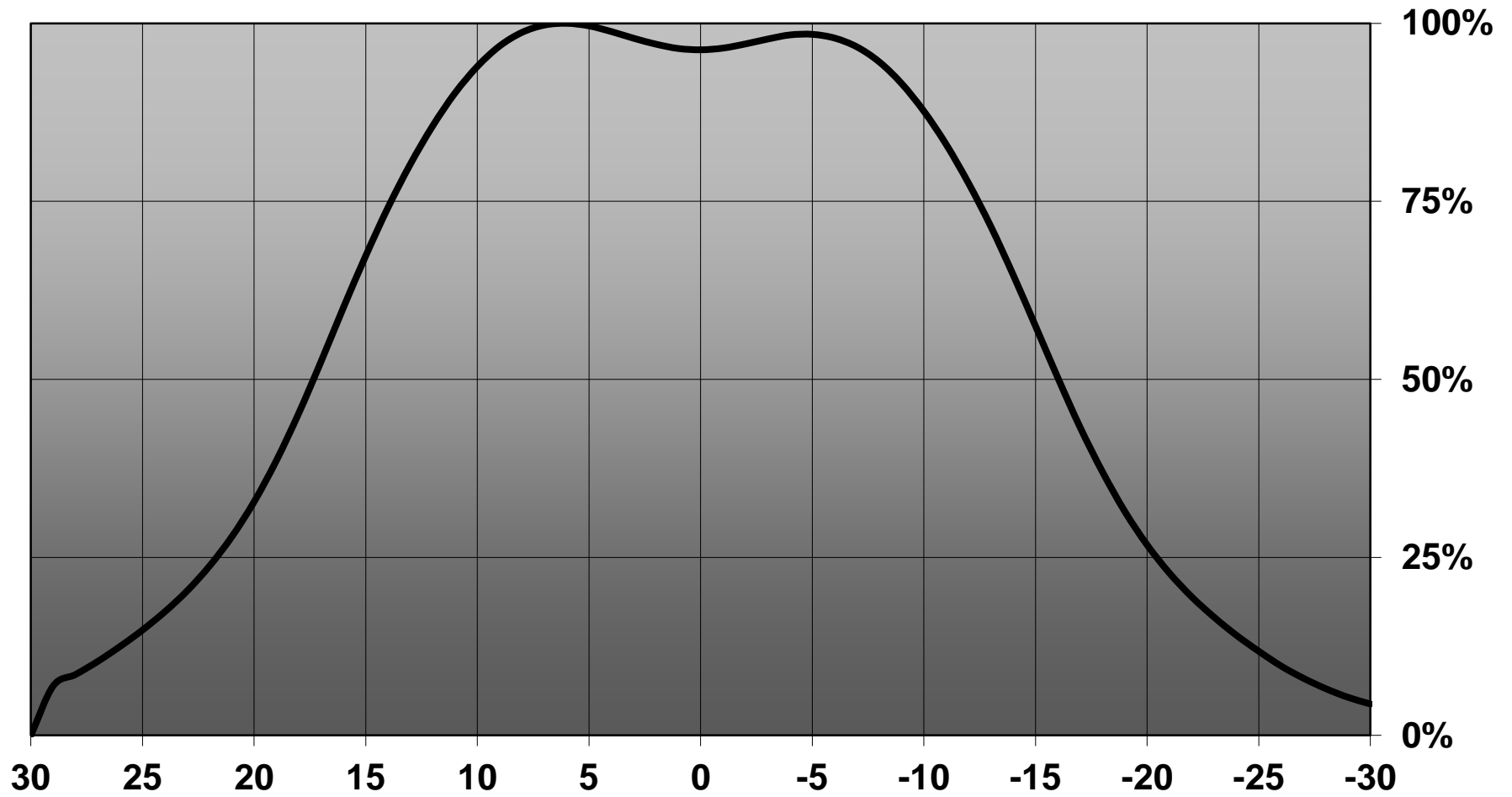

D

C

B

A

4

4

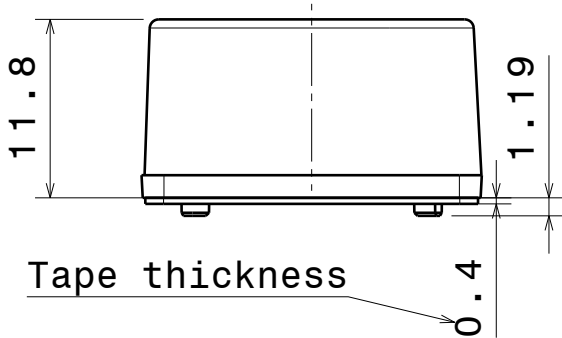

Tape thickness

Front view

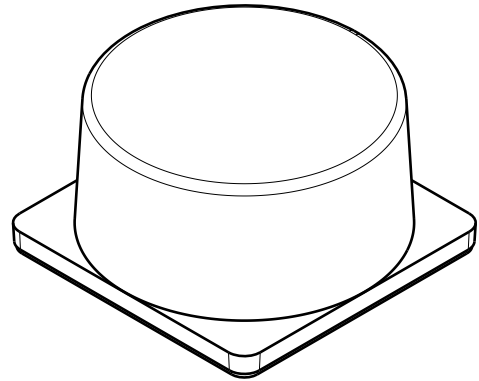

Isometric view

3

3

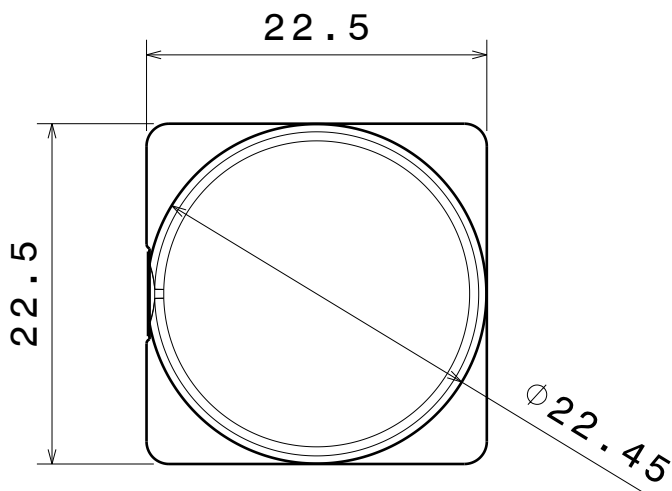

Top view

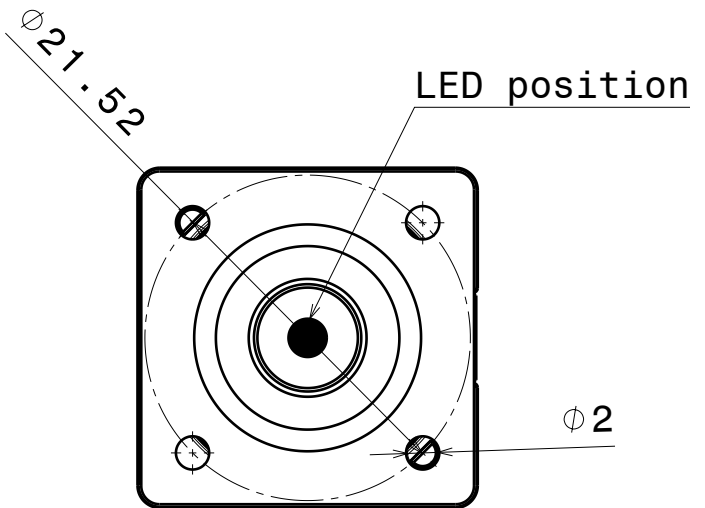

Bottom view

INDEX	PART NO	DESCRIPTION	MATERIAL	COLOUR
1	C14448	VERONICA-SQ-M	PMMA	clear
2	C13729	VERONICA-SQ-TAPE	PU	black

Tolerances if not otherwise shown  
According to DIN ISO 2768-1  
Linear measures: class C  
According to DIN ISO 2768-2  
Form and position: class L

LEDiL

Ledil Oy  
Salorankatu 10  
FIN 24240 SALO  
Finland

THIRD ANGLE PROJECTION:

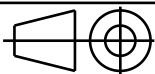

DRAWING TITLE

CA14461\_VERONICA-SQ-M

This drawing is the property  
of LEDiL Oy. It may not be  
reproduced, copied or  
communicated without a written  
agreement with LEDiL Oy.

SIZE PART NUMBER

A4

CA14461

SCALE	2:1	WEIGHT	3,64 g	SHEET	1/1
-------	-----	--------	--------	-------	-----

D

A

1

1

Luminaire: LEDiL Oy CA14461\_VERONICA-SQ-M\_(XP-L)

Lamps: 1 x Cree\_XP-L\_(XPLAWT-0-7A3-U50-0H-0001)\_102.988lm@250mA\_P=0.724035W\_I=0.2499A

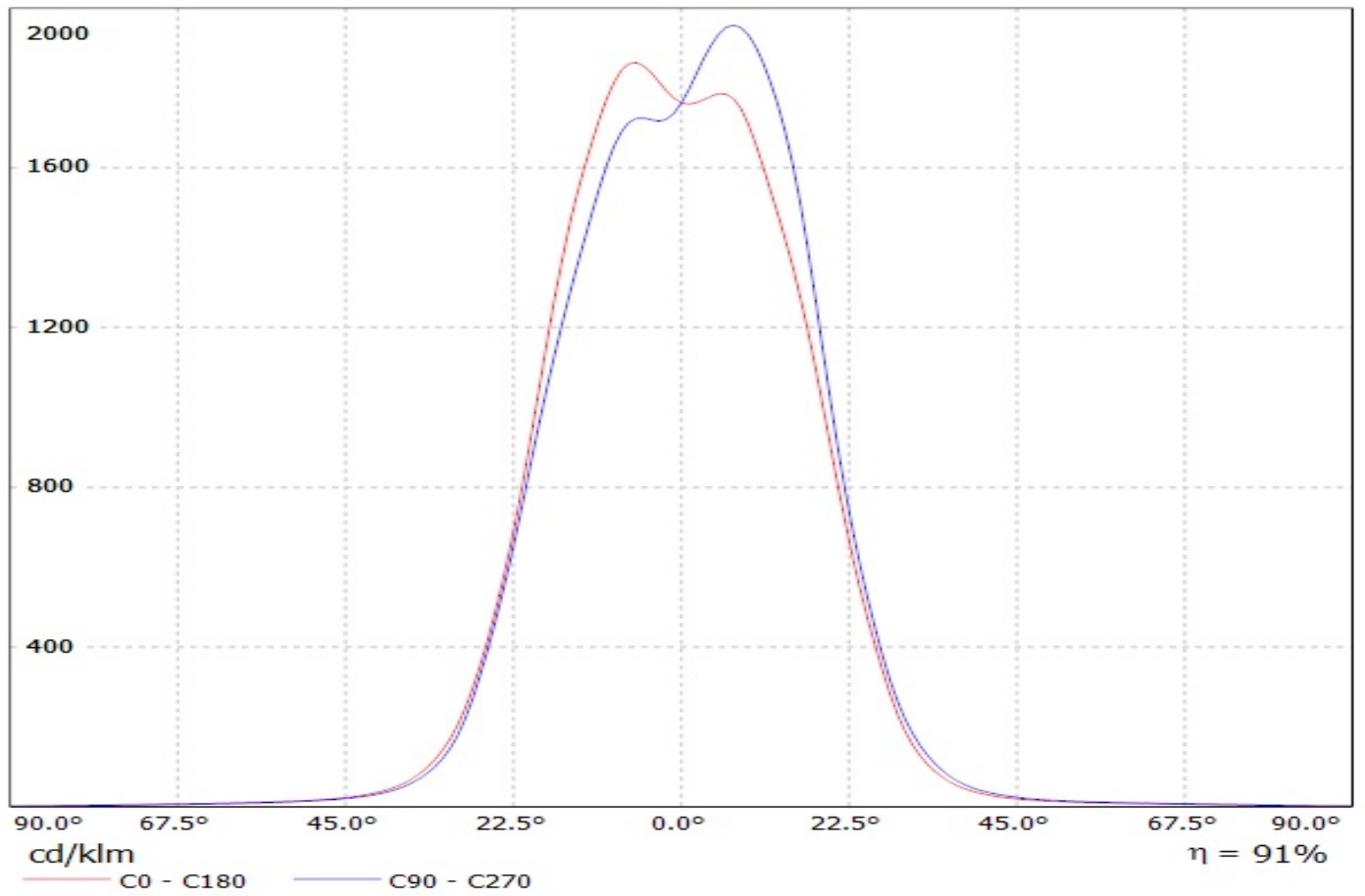



Luminaire: LEDiL Oy CA14461\_VERONICA-SQ-M (Cree\_XM-L)  
Lamps: 1 x Cree\_XM-L\_90.3992lm@250mA\_P=0.735056W\_I=250mA

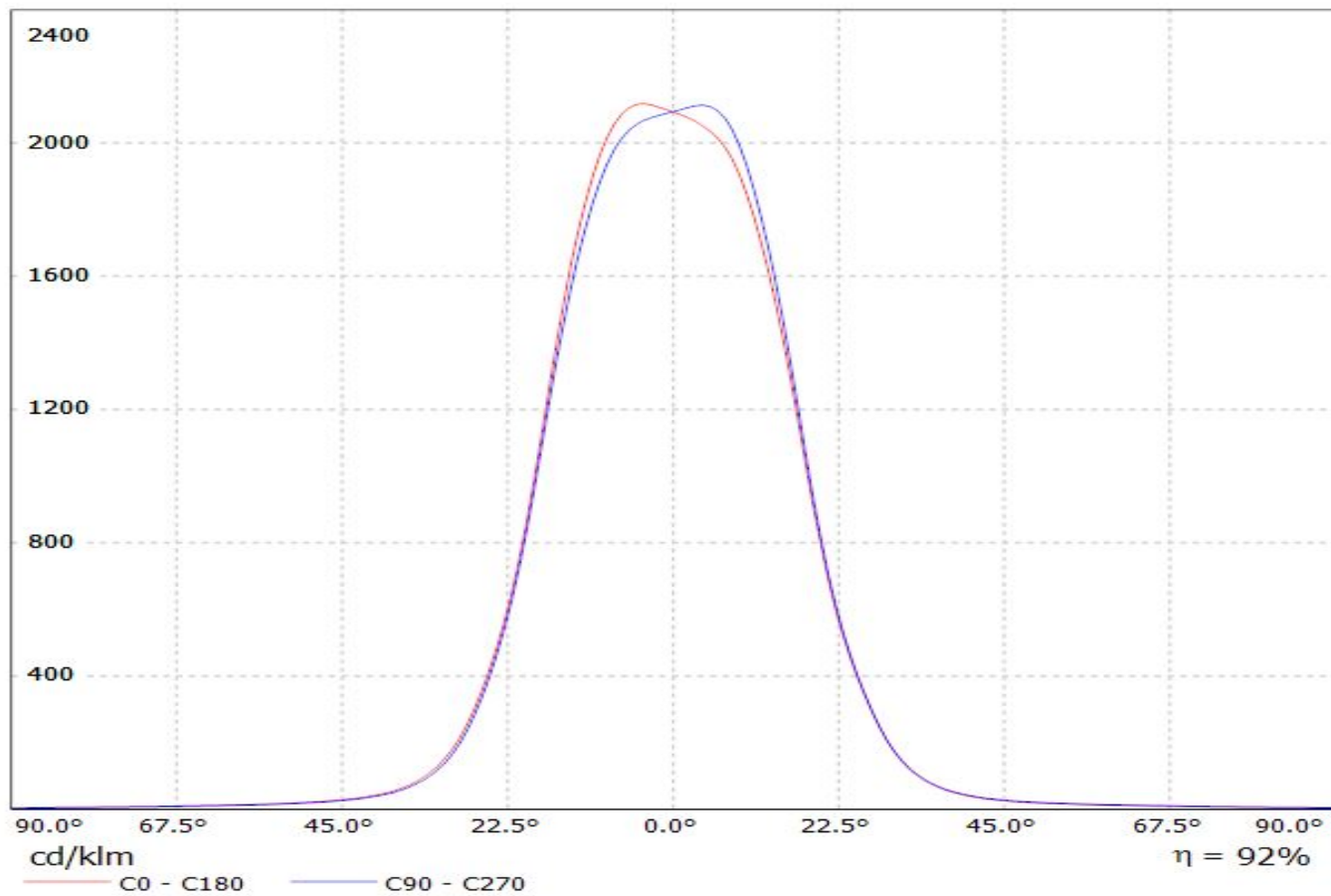

Luminaire: LEDiL Oy CA14461\_VERONICA-SQ-M\_(Cree\_XP-E2)  
Lamps: 1 x Cree\_XP-E2\_79.5831lm@250mA\_P=0.754073W\_I=250mA

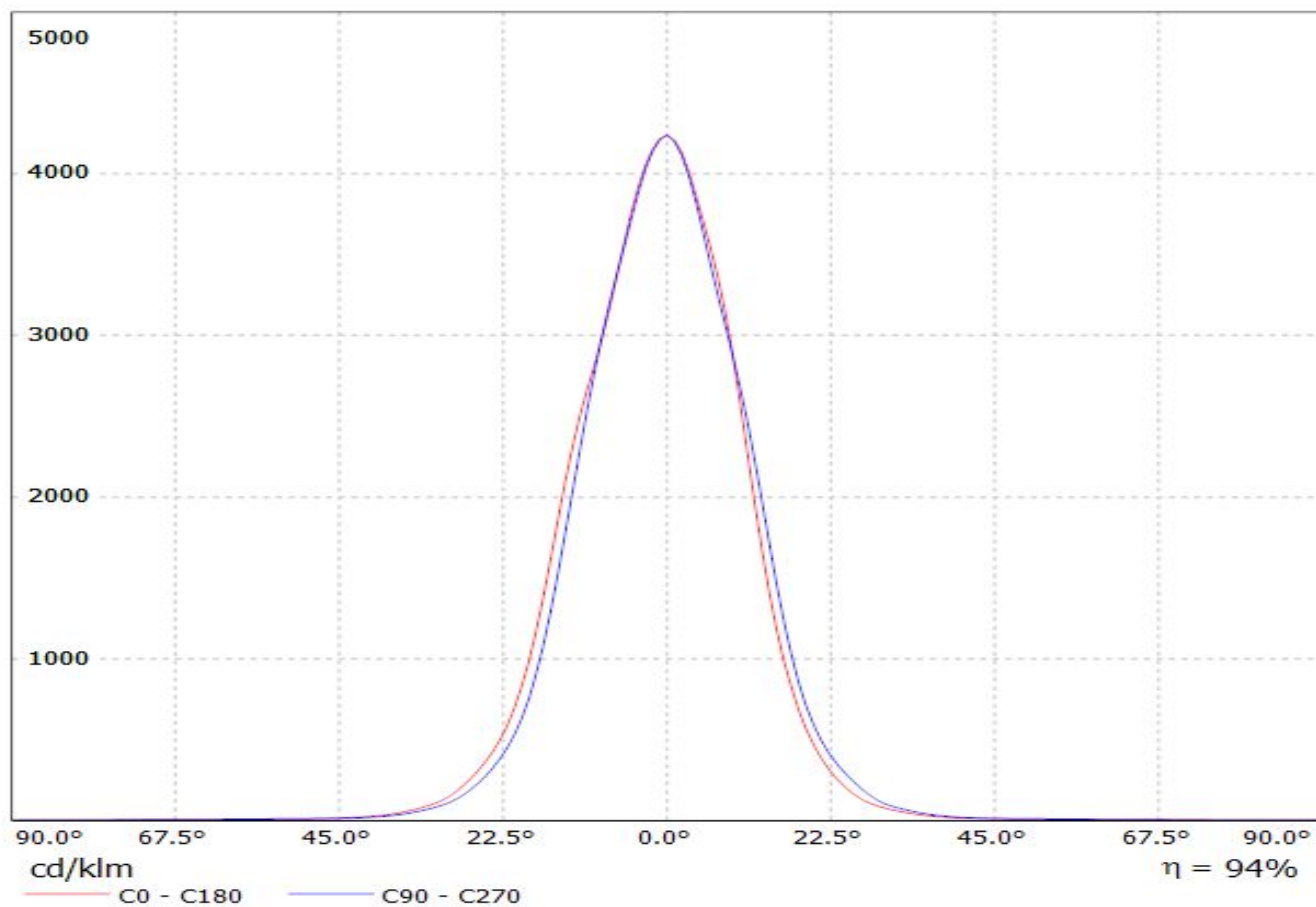

Luminaire: LEDiL Oy CA14461\_VERONICA-SQ-M\_(XP-E)

Lamps: 1 x Cree\_XP-E\_(XPEWHT-L1-3C0-Q5-0-06)\_78.0735lm@250mA\_P=0.803378W\_I=0.2499A

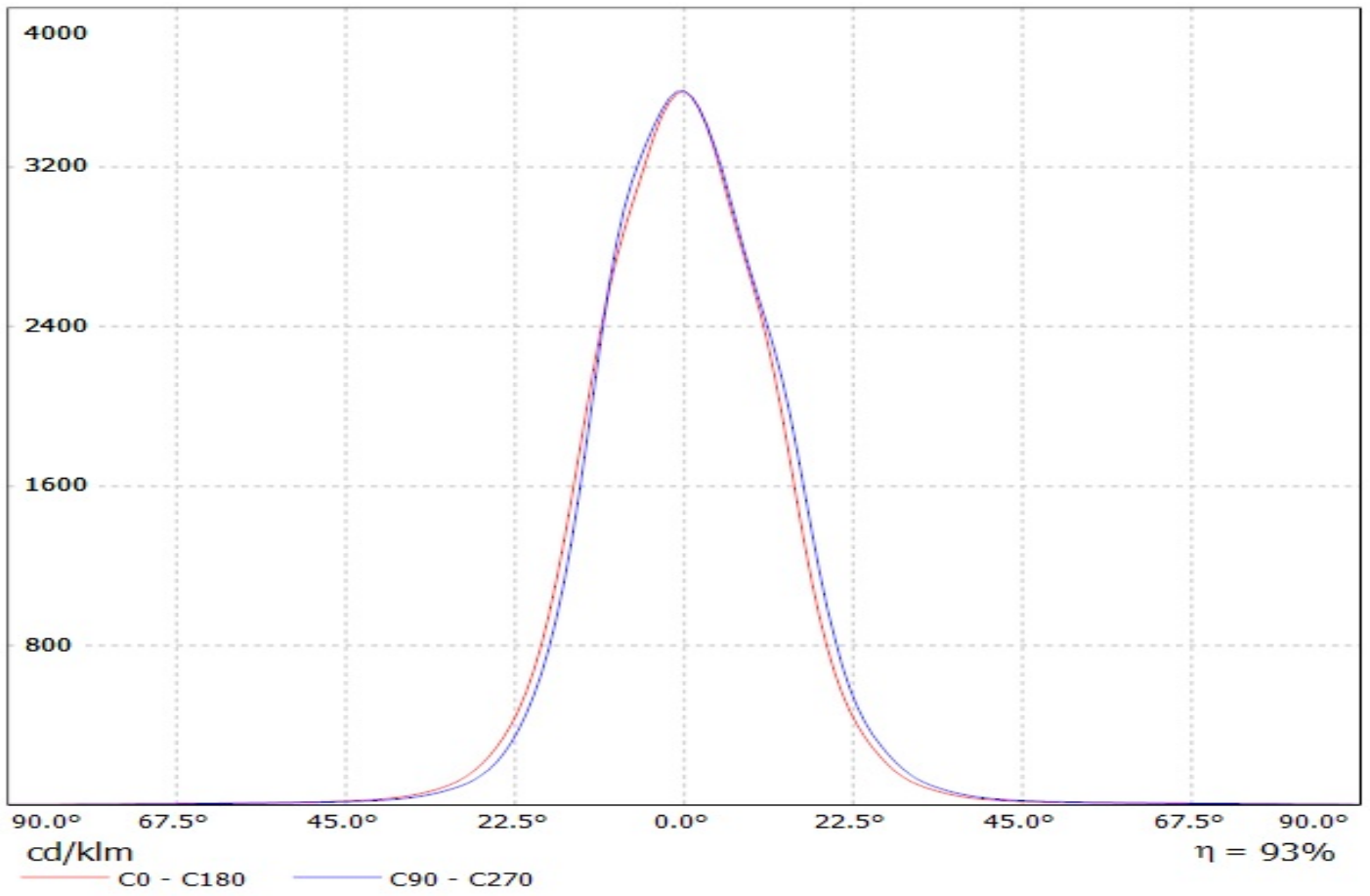

Luminaire: LEDiL Oy CA14461 VERONICA-SQ-M\_(XM-L2)

Lamps: 1 x Cree\_XM-L2\_(XMLBWT-0-7B4-T30-0L-0001)\_95.1239lm@250mA\_P=0.734831W\_I=0.2499A

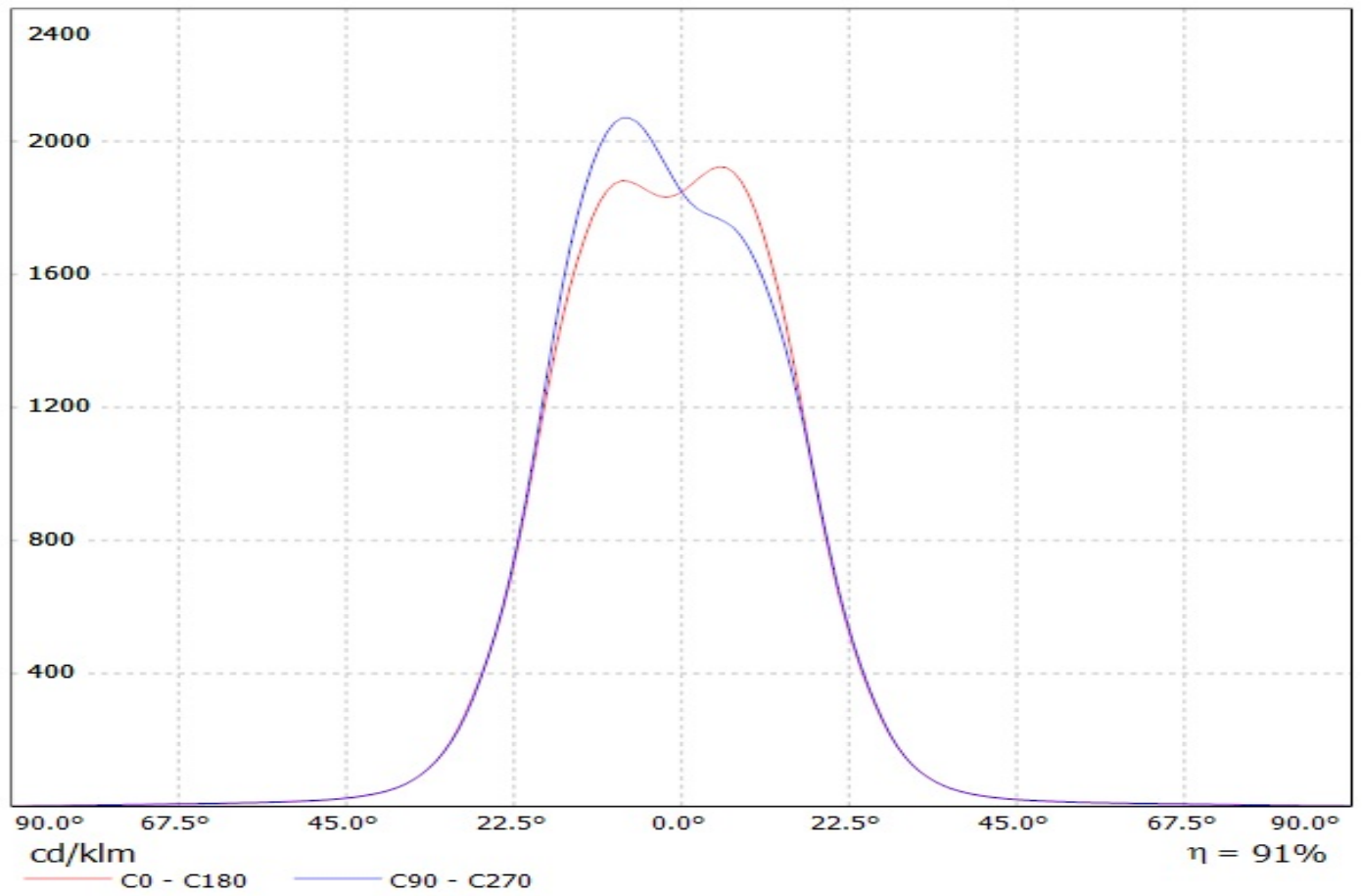

Luminaire: LEDiL Oy CA14461\_VERONICA-SQ-M\_(XB-H)

Lamps: 1 x Cree\_XB-H\_(XBHAWT-0-7C1-T30-0H-0001)\_97.2452lm@250mA\_P=0.755198W\_I=0.2499A

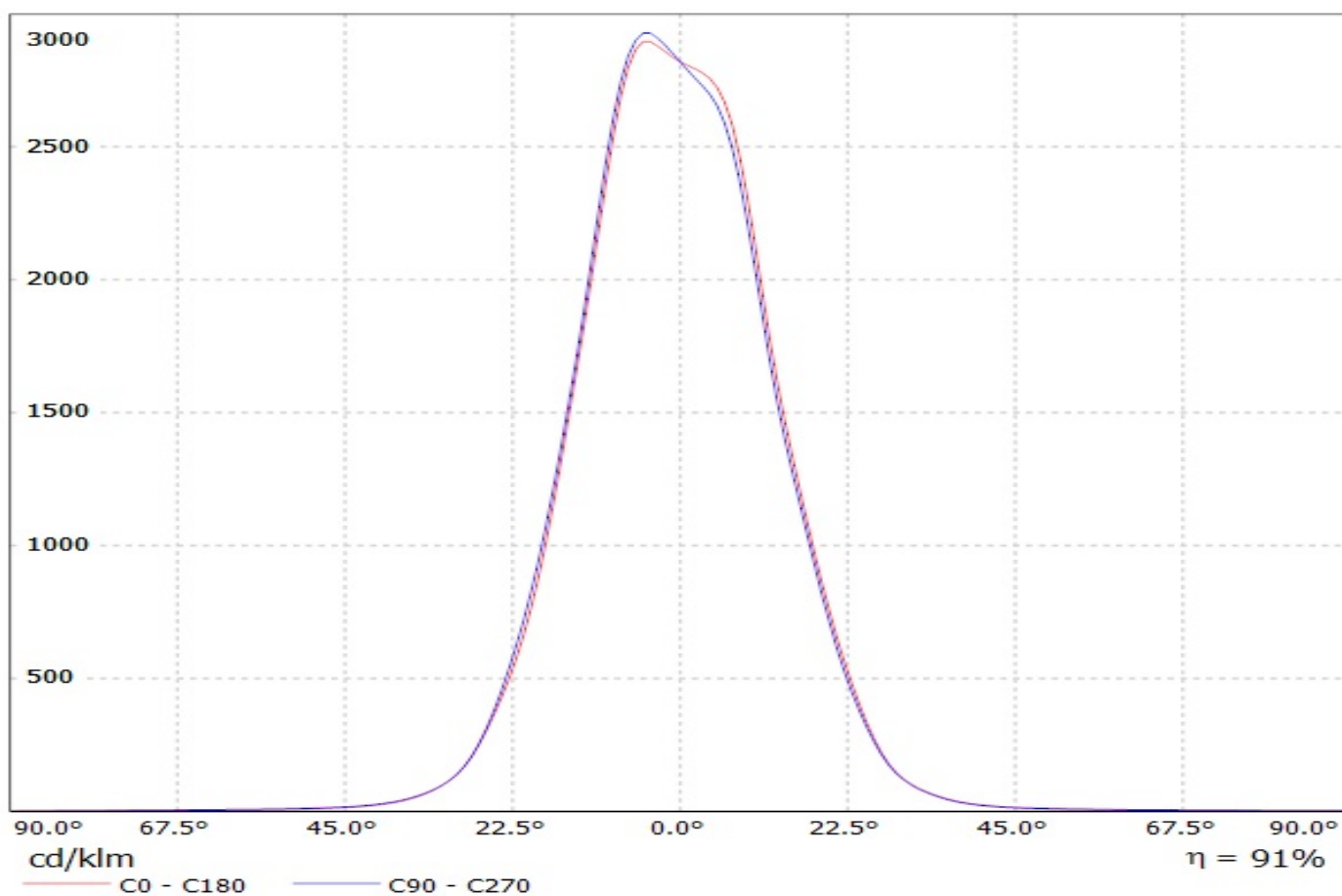

Luminaire: Ledil CA14461\_VERONICA-SQ-M\_(XP-L2)

Lamps: 1 x Cree\_XP-L2\_(XPLWT-00-0000-000HU630G)\_115.868lm@250mA\_P=0.717875W\_I=0.25A

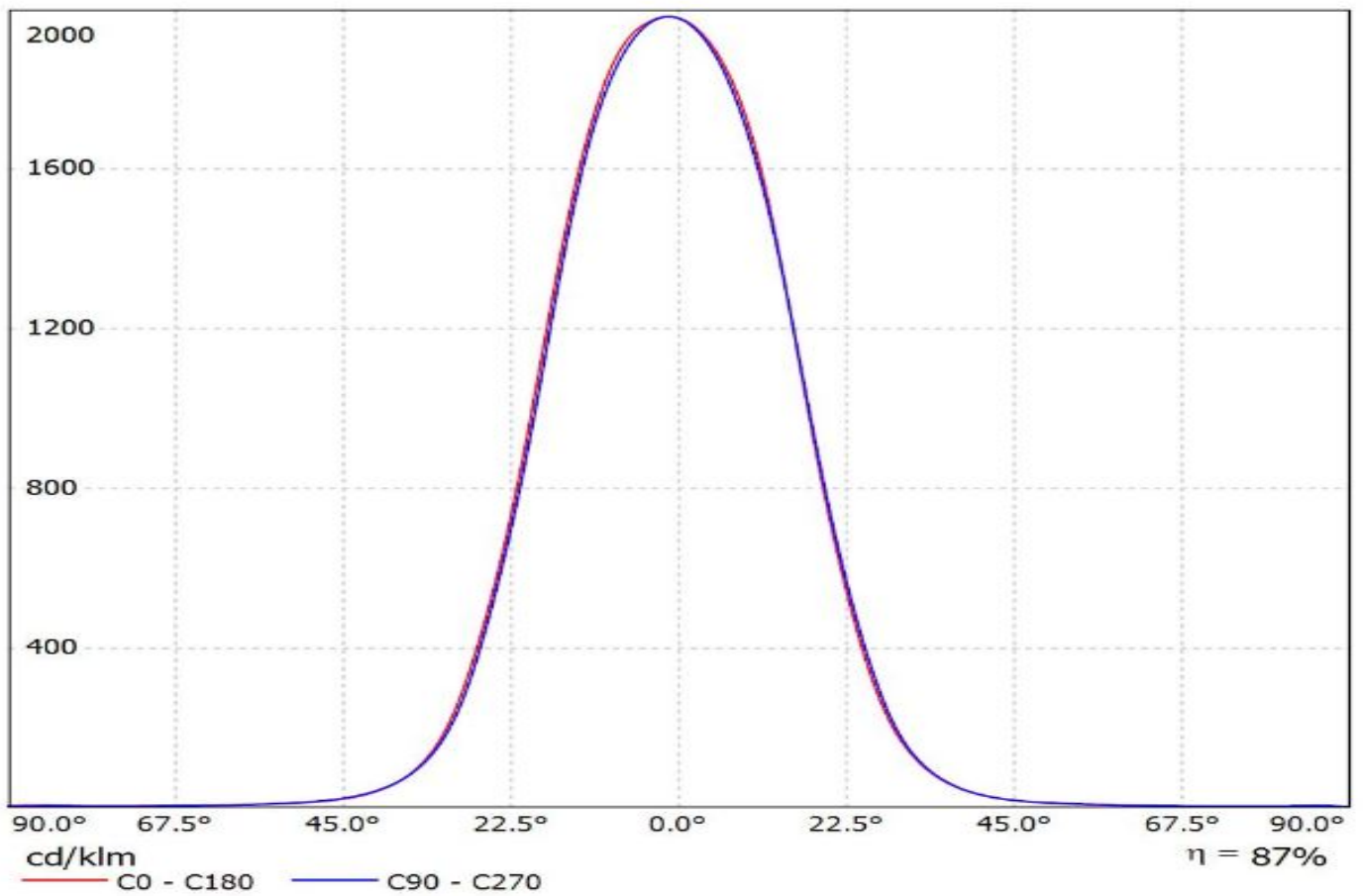

Luminaire: LEDiL Oy CA14461\_VERONICA-SQ-M\_(H35C1)

Lamps: 1 x LG\_H35C1\_(PKG5700K)\_116.036lm@250mA\_CCT=6235K\_P=0.757272W\_I=0.2499A

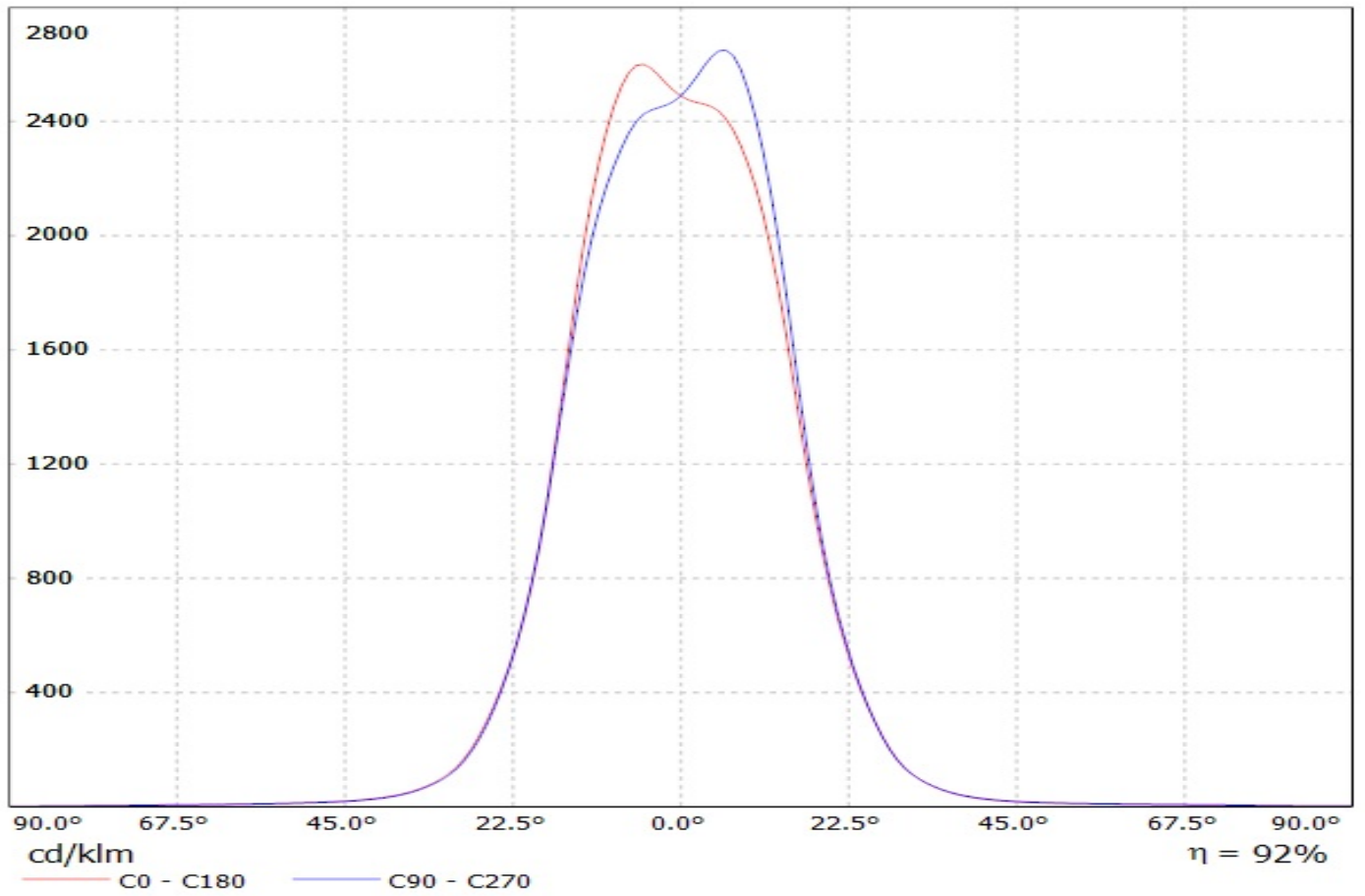

Luminaire: LEDiL Oy CA14461\_VERONICA-SQ-M\_(Luxeon\_MZ)  
Lamps: 1 x Philips\_Lumileds\_Luxeon\_MZ\_386.758lm@250mA\_P=2.77489W\_I=0.2499A

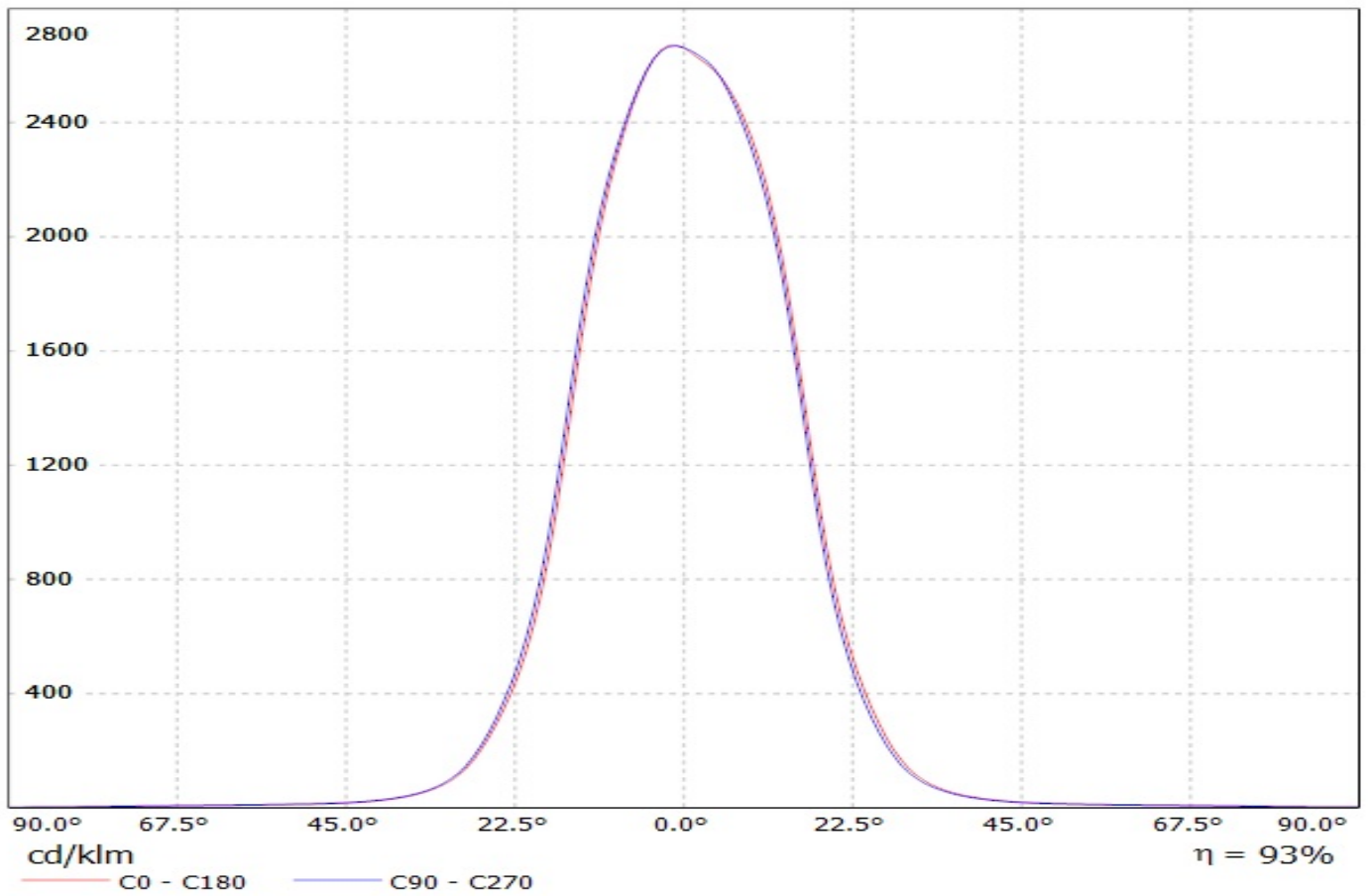



Luminaire: LEDiL Oy CA14461\_VERONICA-SQ-M\_(Luxeon\_R)

Lamps: 1 x Philips\_Lumileds\_Luxeon\_R\_(LXA7-PW30)\_74.1293lm@250mA\_CCT=3049K\_P=0.727484W\_I=0.2499A

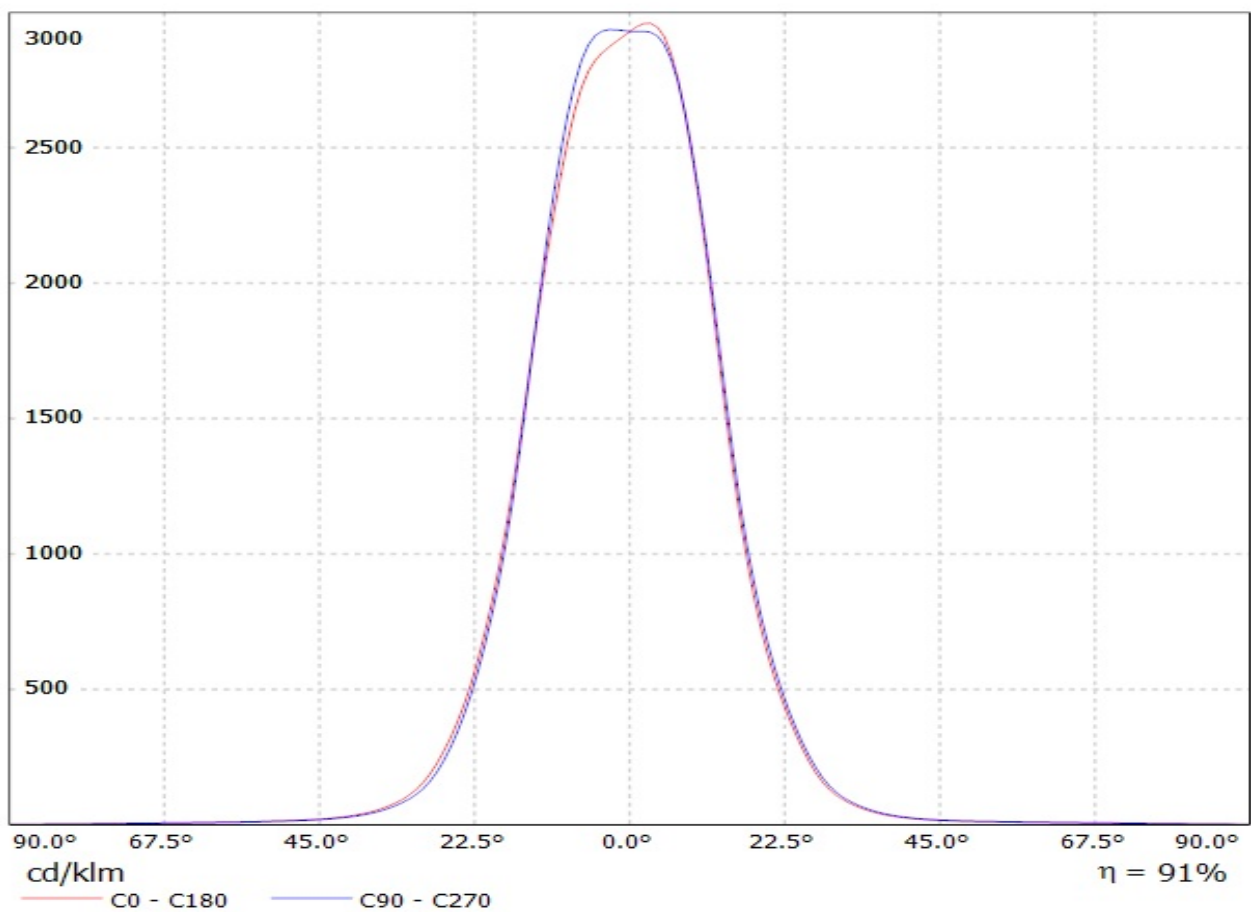

Luminaire: LEDiL Oy CA14461\_VERONICA-SQ-M\_(Luxeon\_Rebel)

Lamps: 1 x Philips\_Lumileds\_Luxeon\_Rebel\_(LXM8-PW30)\_61.1293lm@250mA\_P=0.728758W\_I=0.2499A

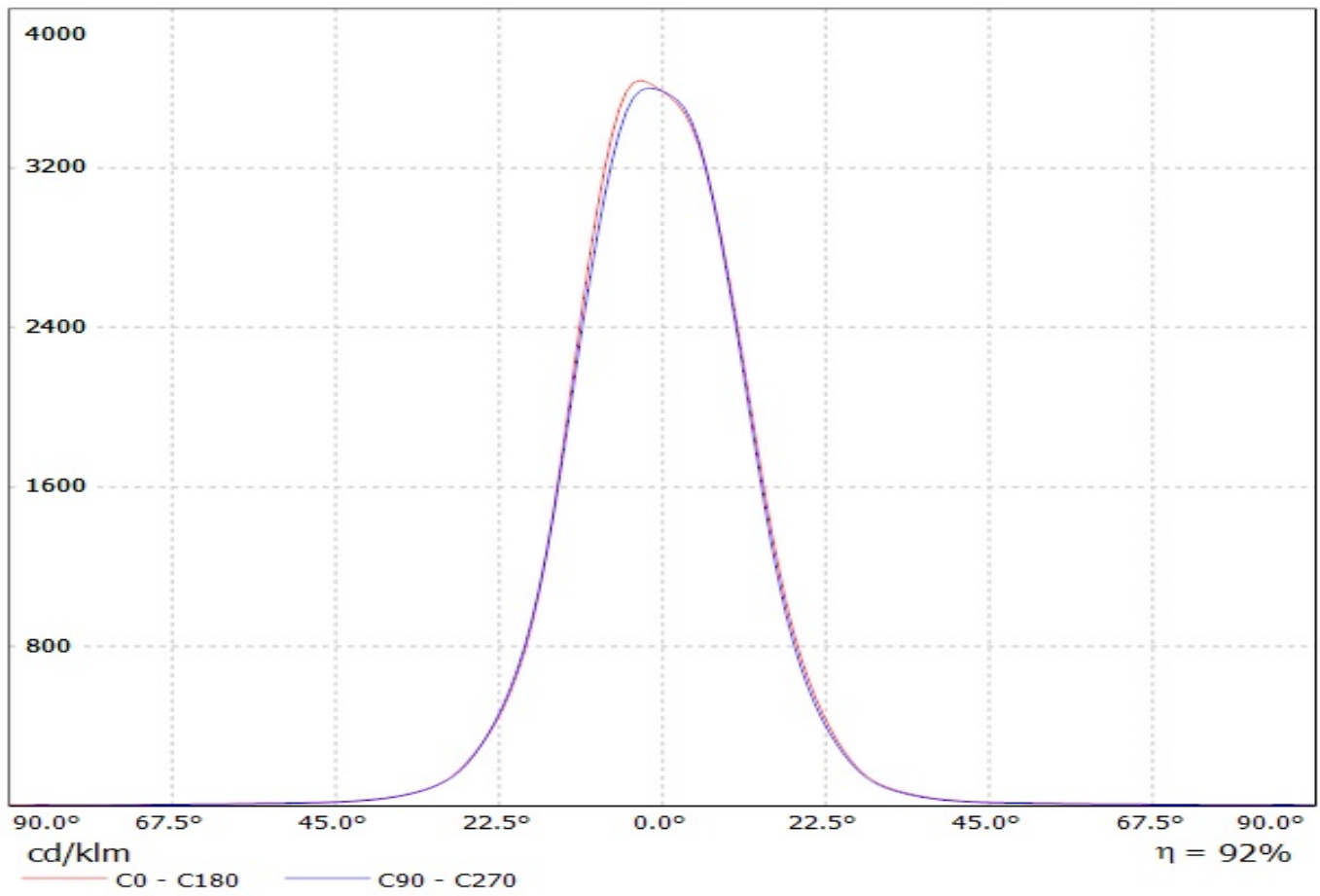

Luminaire: LEDiL Oy CA14461\_VERONICA-SQ-M\_(Luxeon\_T)

Lamps: 1 x Philips\_Lumileds\_Luxeon\_T\_(LXH8-FW30-3)\_72.2743lm@250mA\_P=0.734231W\_I=0.2499A

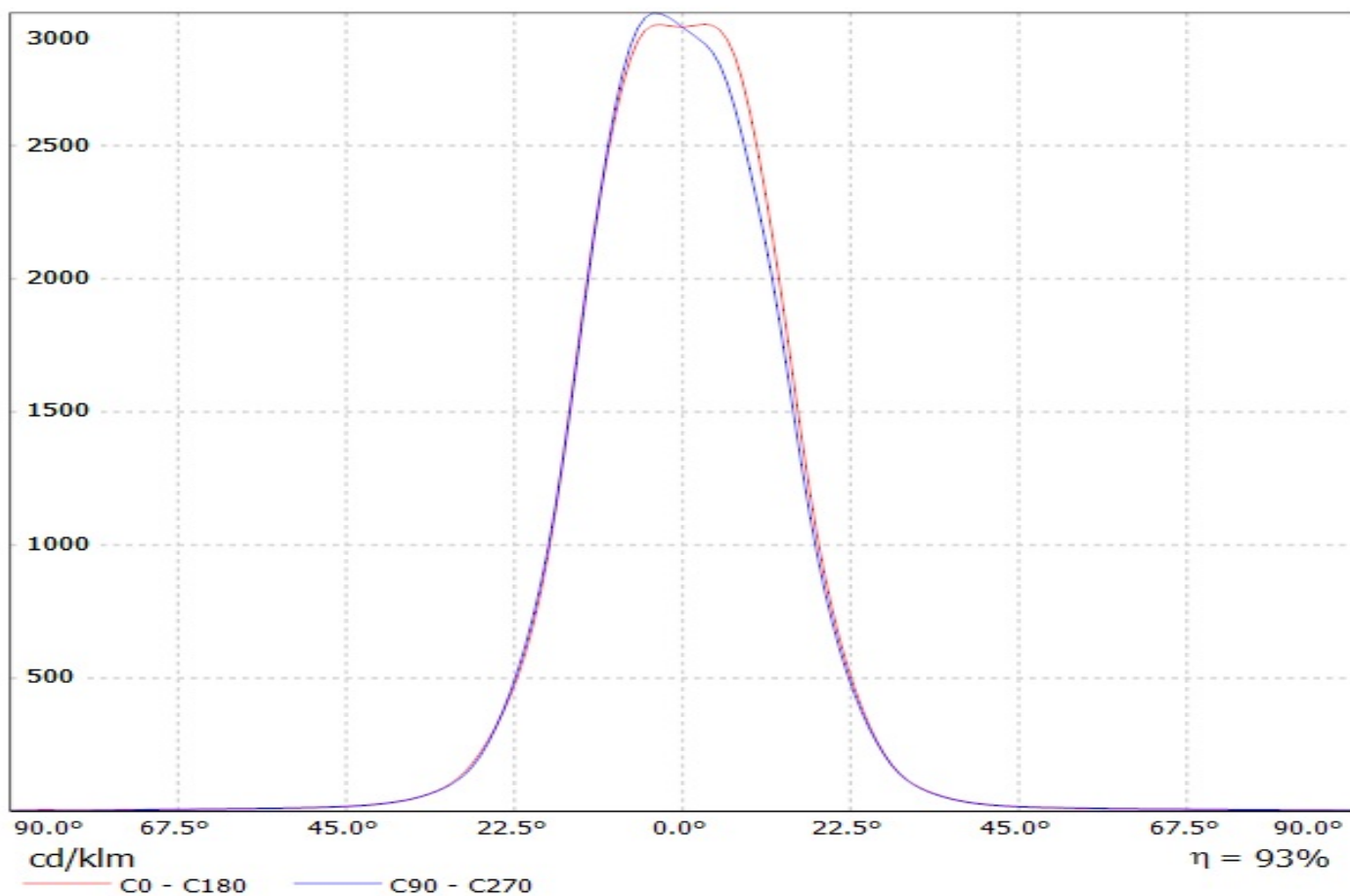

Luminaire: LEDiL Oy CA14461\_VERONICA-SQ-M\_(Luxeon\_TX)

Lamps: 1 x Philips\_Lumileds\_Luxeon\_TX\_(L1T2-3585)\_80.8039lm@250mA\_CCT=3554K\_P=0.740679W\_I=0.2499A

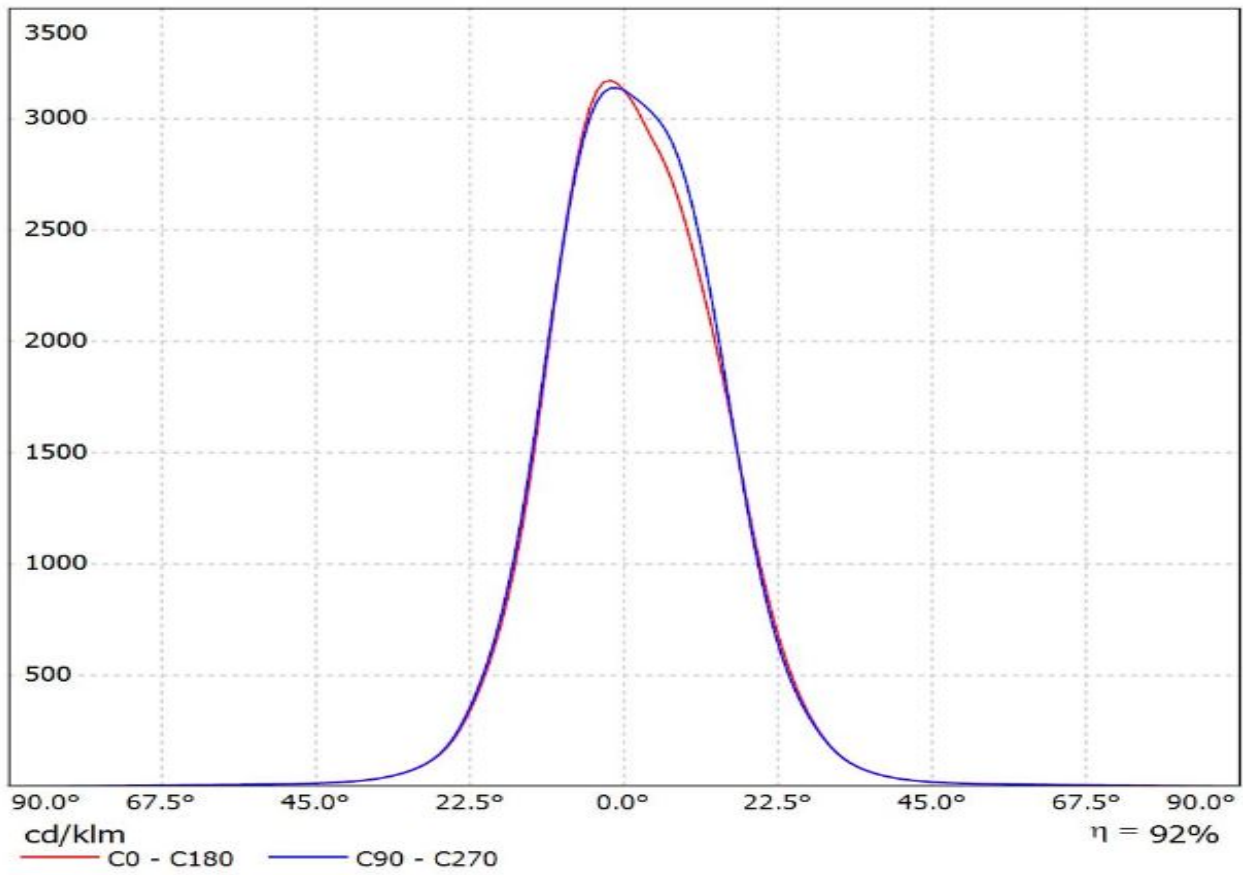

Luminaire: LEDiL Oy CA14461\_VERONICA-SQ-M\_(Luxeon\_Rebel\_ES)

Lamps: 1 x Philips\_Lumileds\_Luxeon\_Rebel\_ES\_(LXML-PWC2)\_89.4472lm@250mA\_P=0.746101W\_I=0.2499A

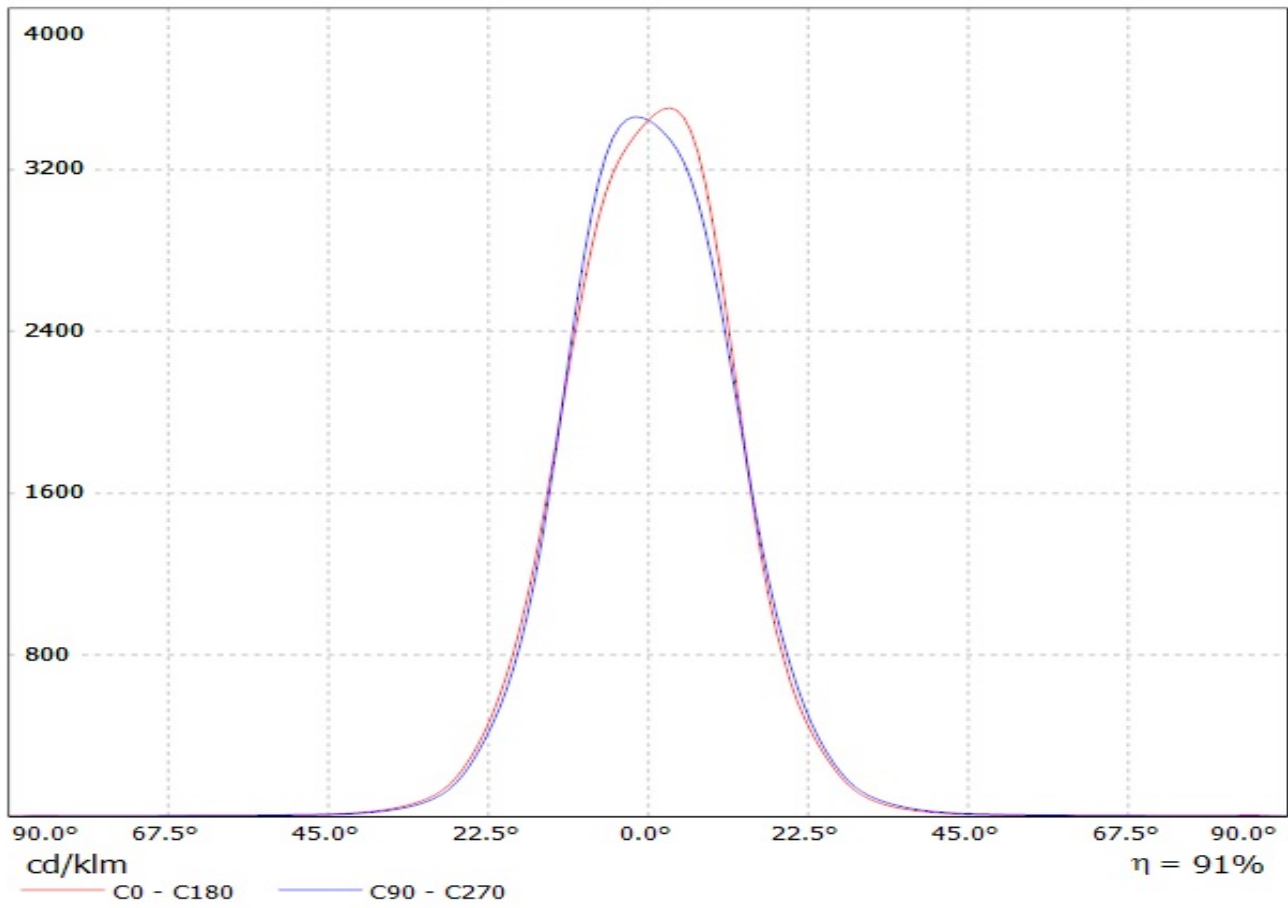

Luminaire: LEDiL Oy CA14461\_VERONICA-SQ-M\_(Luxeon\_A)

Lamps: 1 x Philips\_Lumileds\_Luxeon\_A\_(LXH8-PW30)\_65.8365lm@250mA\_P=0.727284W\_I=0.2499A

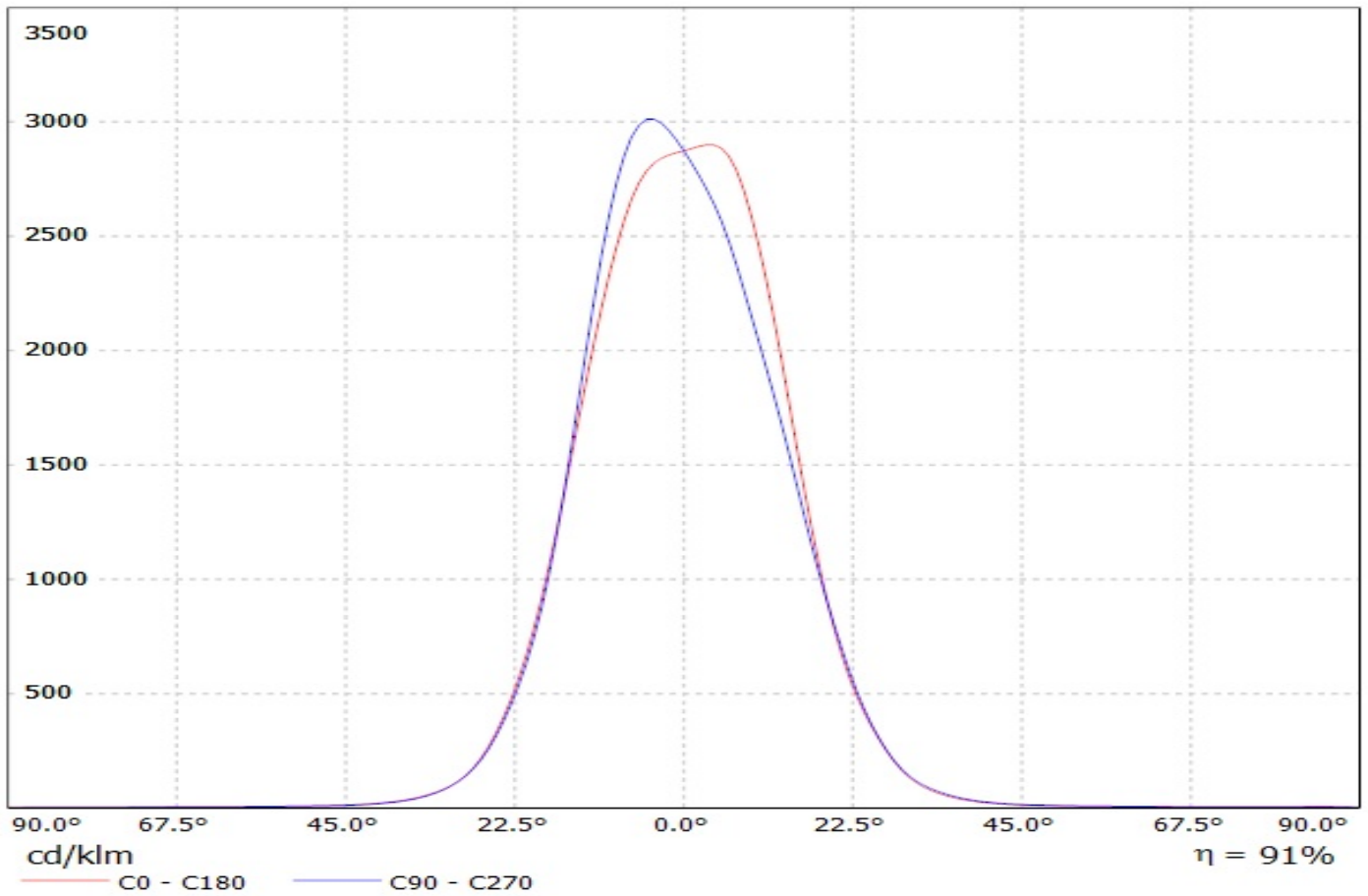

Luminaire: LEDiL Oy CA14461\_VERONICA-SQ-M\_(Nichia\_NVsxx19B)  
Lamps: 1 x Nichia\_NVsxx19B\_105.826lm@250mA\_P=0.731182W\_I=250mA

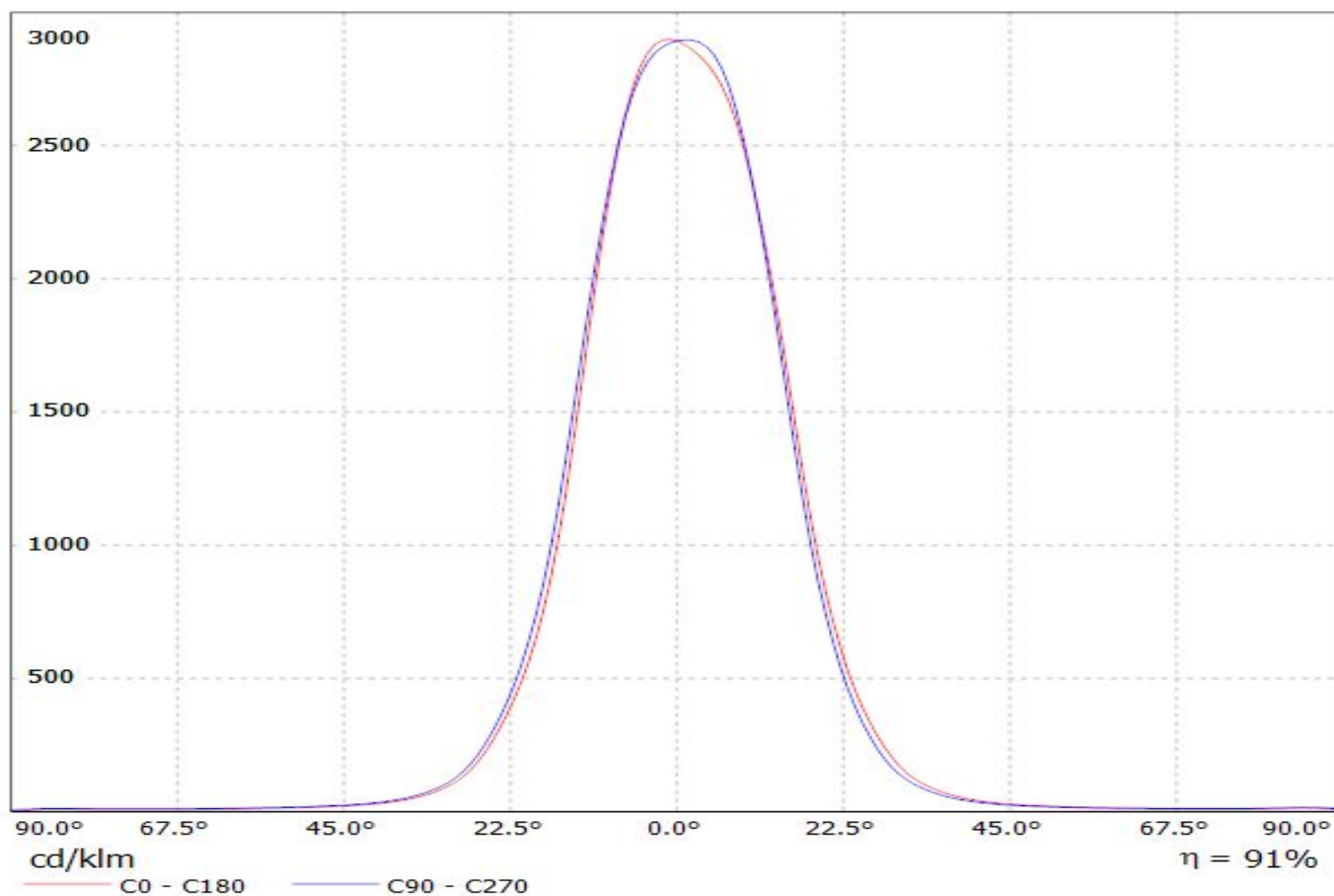

Luminaire: LEDiL Oy CA14461\_VERONICA-SQ-M\_(Nichia\_NCSxx19B)  
Lamps: 1 x Nichia\_NCSxx19B\_90.3281lm@250mA\_P=0.795931W\_I=250mA

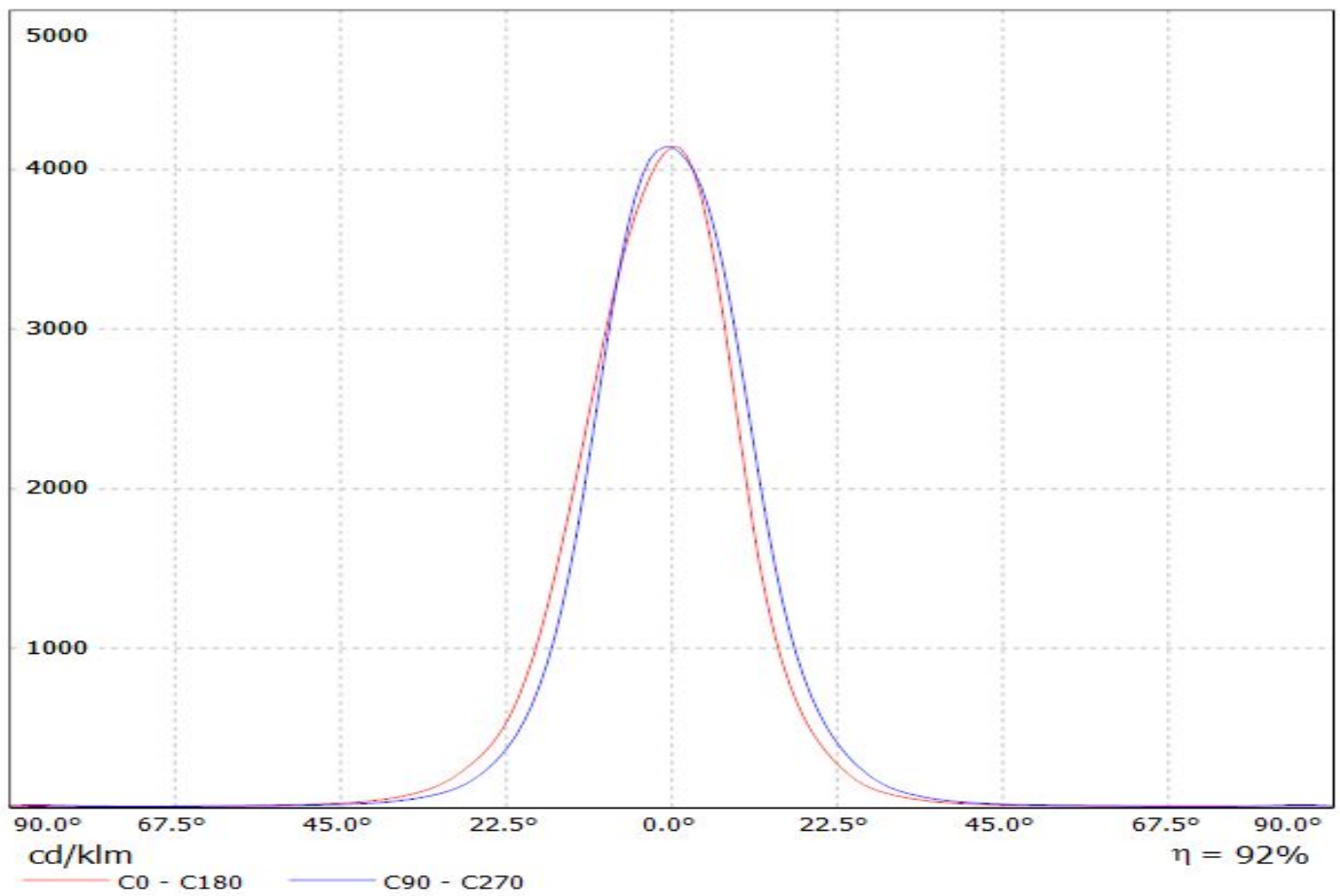



Luminaire: LEDiL Oy CA14442\_VERONICA-SQ-W\_(NWSL229AE)

Lamps: 1 x Nichia\_NWSL229AE\_120.54lm@250mA\_P=0.7128W\_I=0.250A

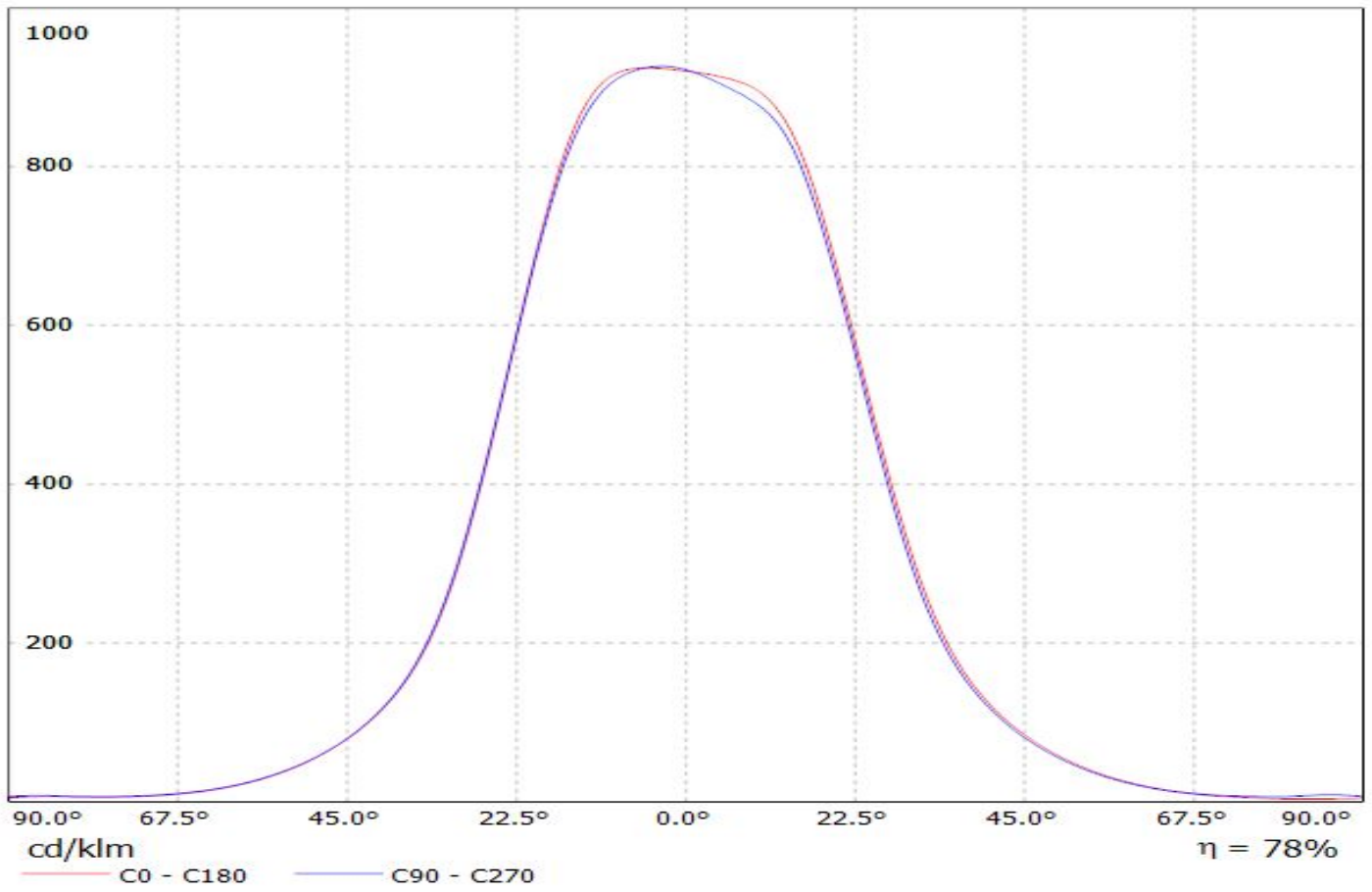

Luminaire: LEDiL Oy CA14461\_VERONICA-SQ-M (Oslon\_Square\_PC)

Lamps: 1 x Osram\_Oslon\_Square-PC\_(LCW\_CQAR.PL-MSMV-5H71-1)\_99.714lm@250mA\_P=0.770717W\_I=0.2499A

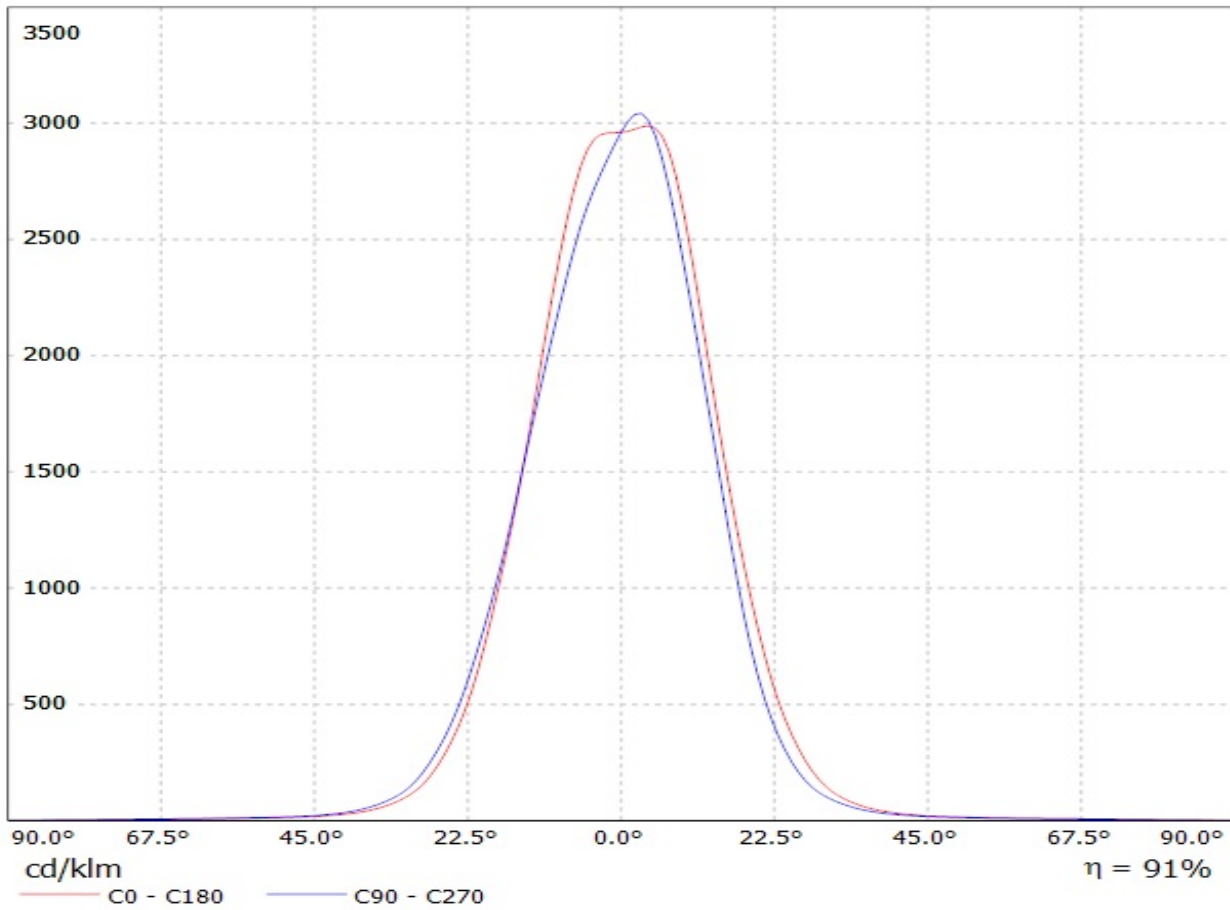

Luminaire: LEDiL Oy CA14461\_VERONICA-SQ-M\_(Oslon\_Square\_EC)

Lamps: 1 x Osram\_Oslon\_Square\_EC\_(GW\_CSSRM1.EC)\_85.3477lm@250mA\_P=0.738904W\_I=0.2499A

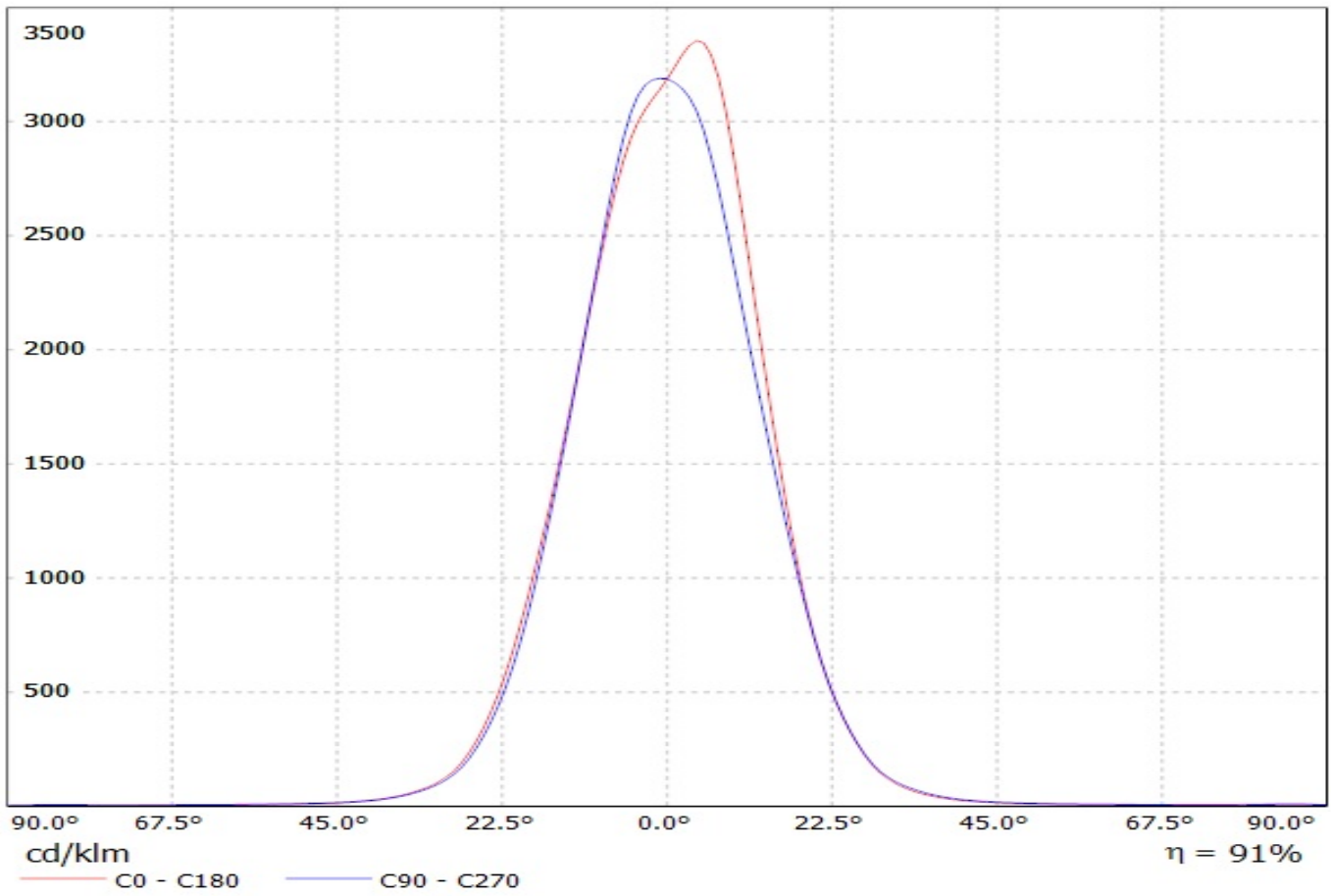

Luminaire: LEDiL Oy CA14461\_VERONICA-SQ-M\_(Z8Y22plus)

Lamps: 1 x Seoul\_Z8Y22plus\_(W6E2G)\_125.652lm@250mA\_P=0.69312W\_I=0.250A

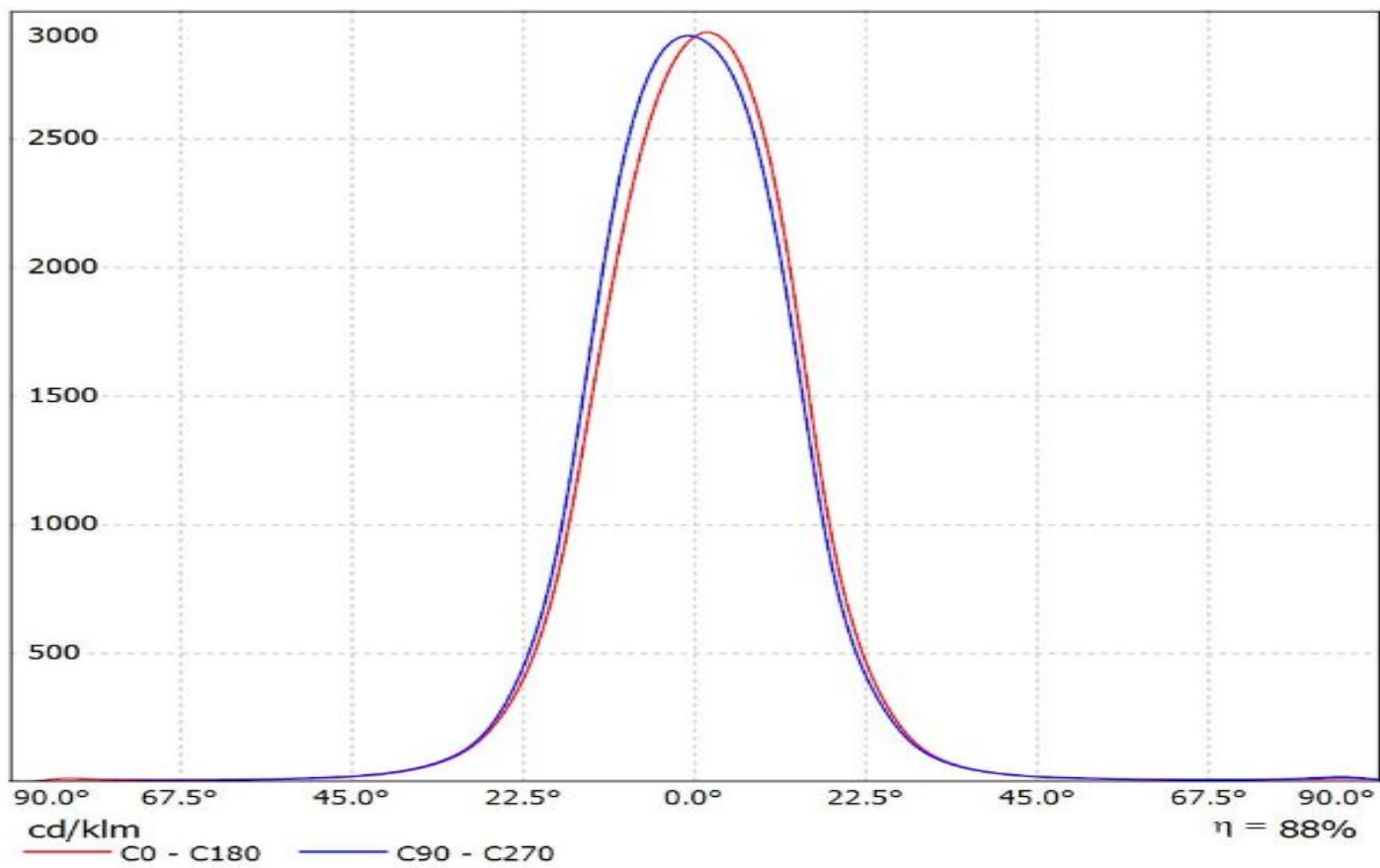

Luminaire: LEDiL Oy CA14461\_VERONICA-SQ-M\_(XP-L)

Lamps: 1 x Cree\_XP-L\_(XPLAWT-0-7A3-U50-0H-0001)\_102.988lm@250mA\_P=0.724035W\_I=0.2499A

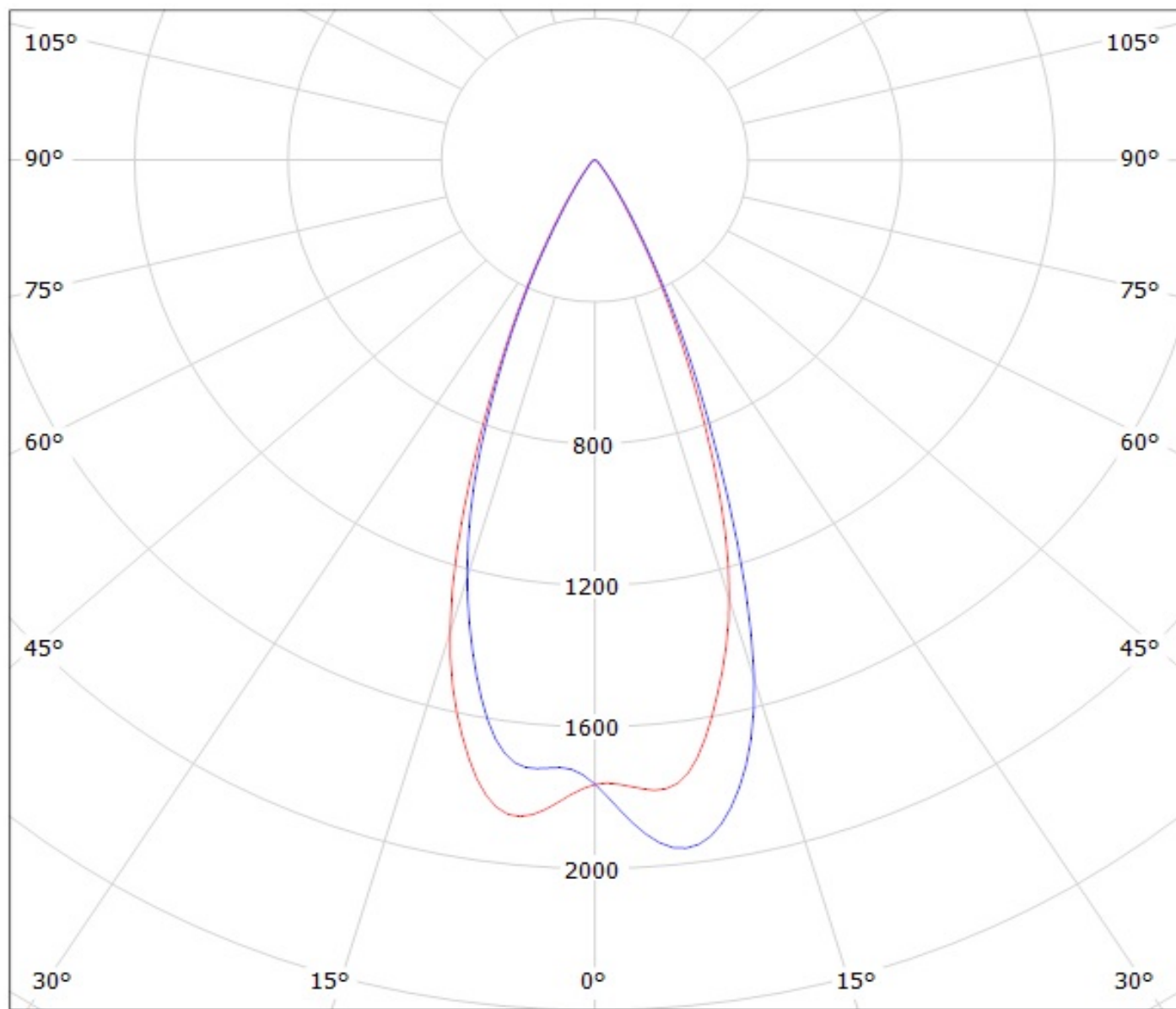

cd/klm

— C0 - C180

— C90 - C270

$\eta = 91\%$

Luminaire: LEDiL Oy CA14461\_VERONICA-SQ-M\_(Cree\_XM-L)  
Lamps: 1 x Cree\_XM-L\_90.3992lm@250mA\_P=0.735056W\_I=250mA

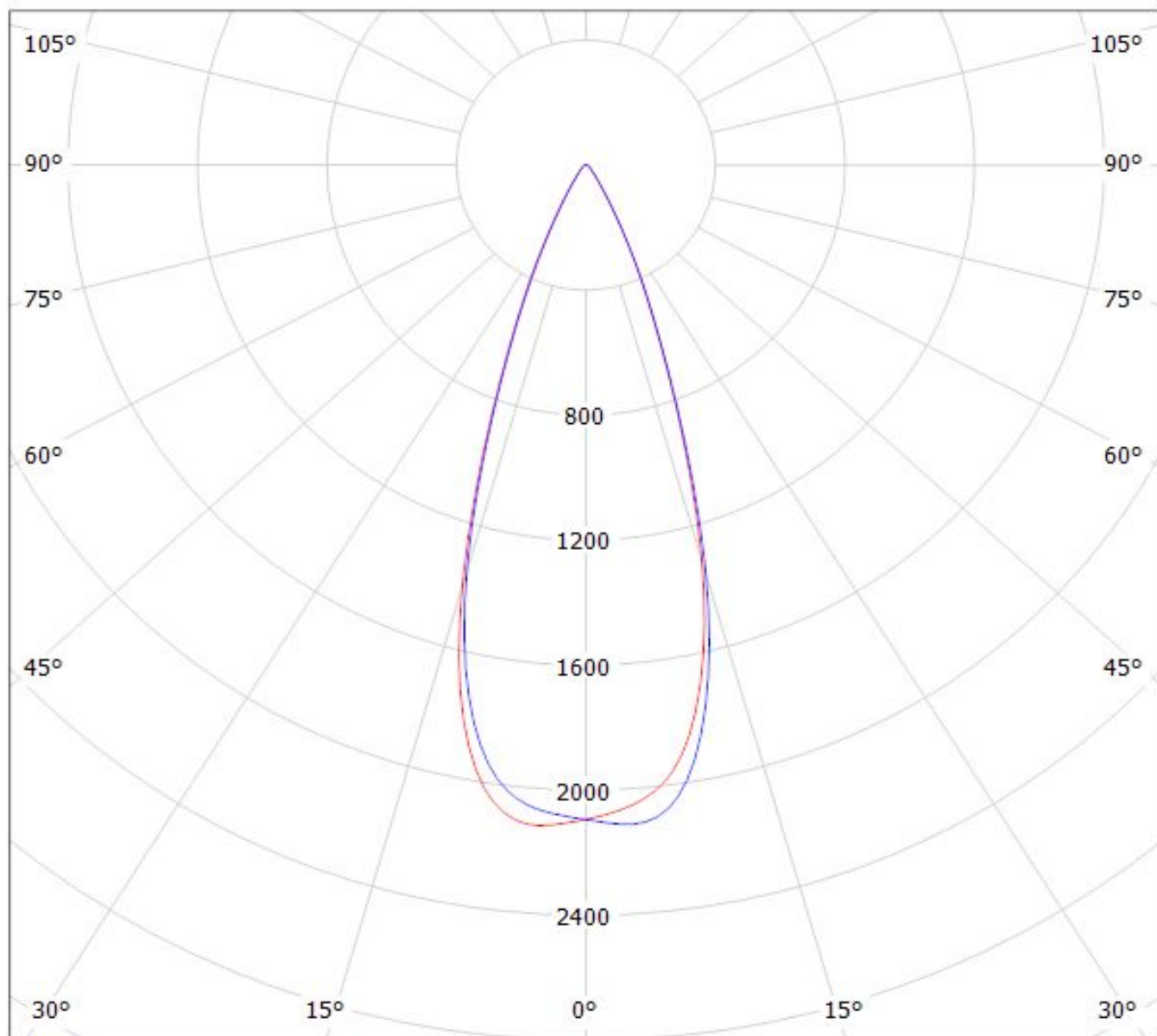

cd/klm

$\eta = 92\%$

— C0 - C180    — C90 - C270

Luminaire: LEDiL Oy CA14461\_VERONICA-SQ-M\_(Cree\_XP-E2)  
Lamps: 1 x Cree\_XP-E2\_79.5831lm@250mA\_P=0.754073W\_I=250mA

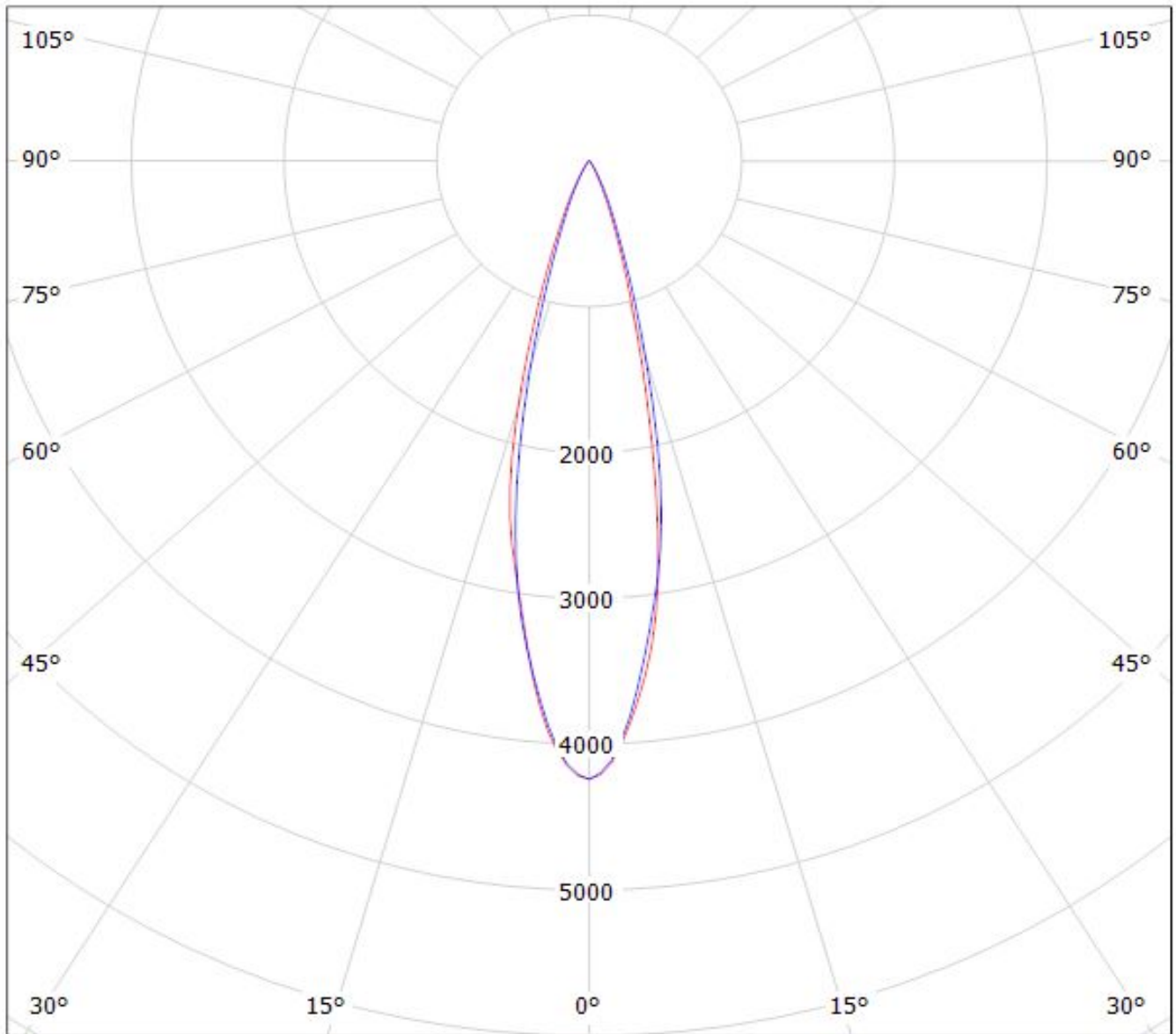

$\eta = 94\%$

cd/klm  
— C0 - C180    — C90 - C270



Luminaire: LEDiL Oy CA14461\_VERONICA-SQ-M\_(XP-E)

Lamps: 1 x Cree\_XP-E\_(XPEWHT-L1-3C0-Q5-0-06)\_78.0735lm@250mA\_P=0.803378W\_I=0.2499A

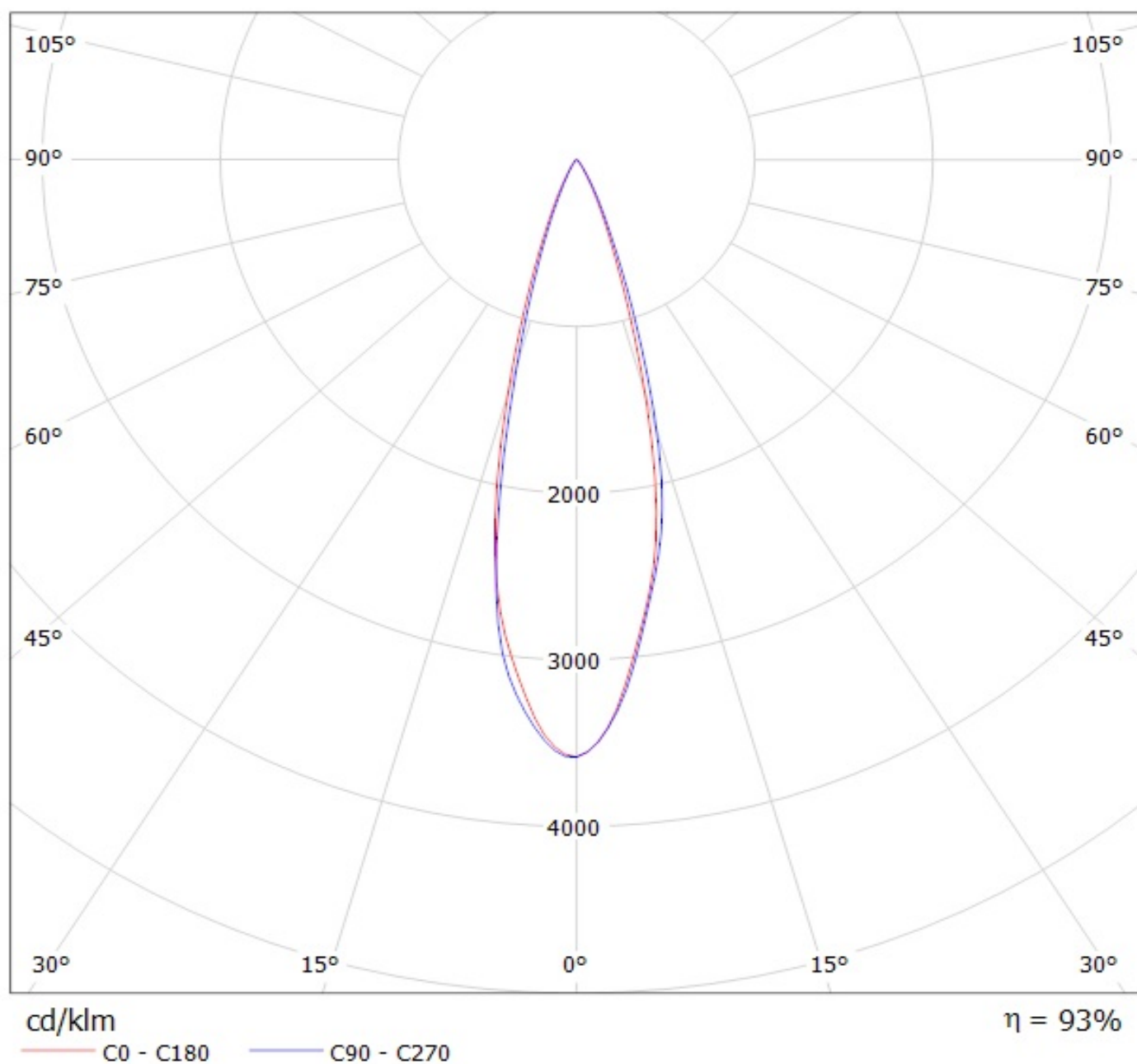



Luminaire: LEDiL Oy CA14461\_VERONICA-SQ-M\_(XM-L2)

Lamps: 1 x Cree\_XM-L2\_(XMLBWT-0-7B4-T30-0L-0001)\_95.1239lm@250mA\_P=0.734831W\_I=0.2499A

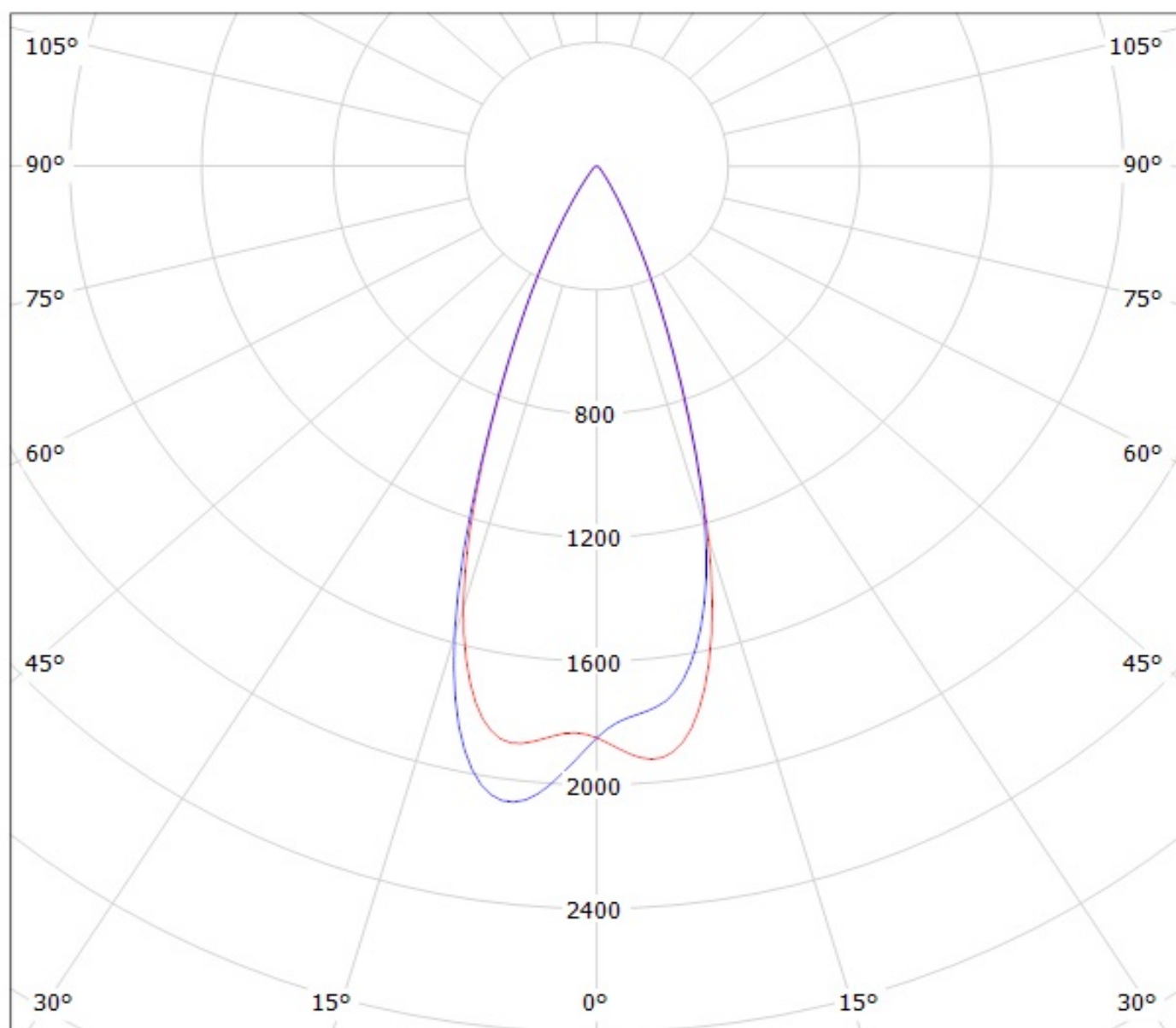

cd/klm

— C0 - C180

— C90 - C270

$\eta = 91\%$

Luminaire: LEDiL Oy CA14461\_VERONICA-SQ-M\_(XB-H)

Lamps: 1 x Cree\_XB-H\_(XBHAWT-0-7C1-T30-0H-0001)\_97.2452lm@250mA\_P=0.755198W\_I=0.2499A

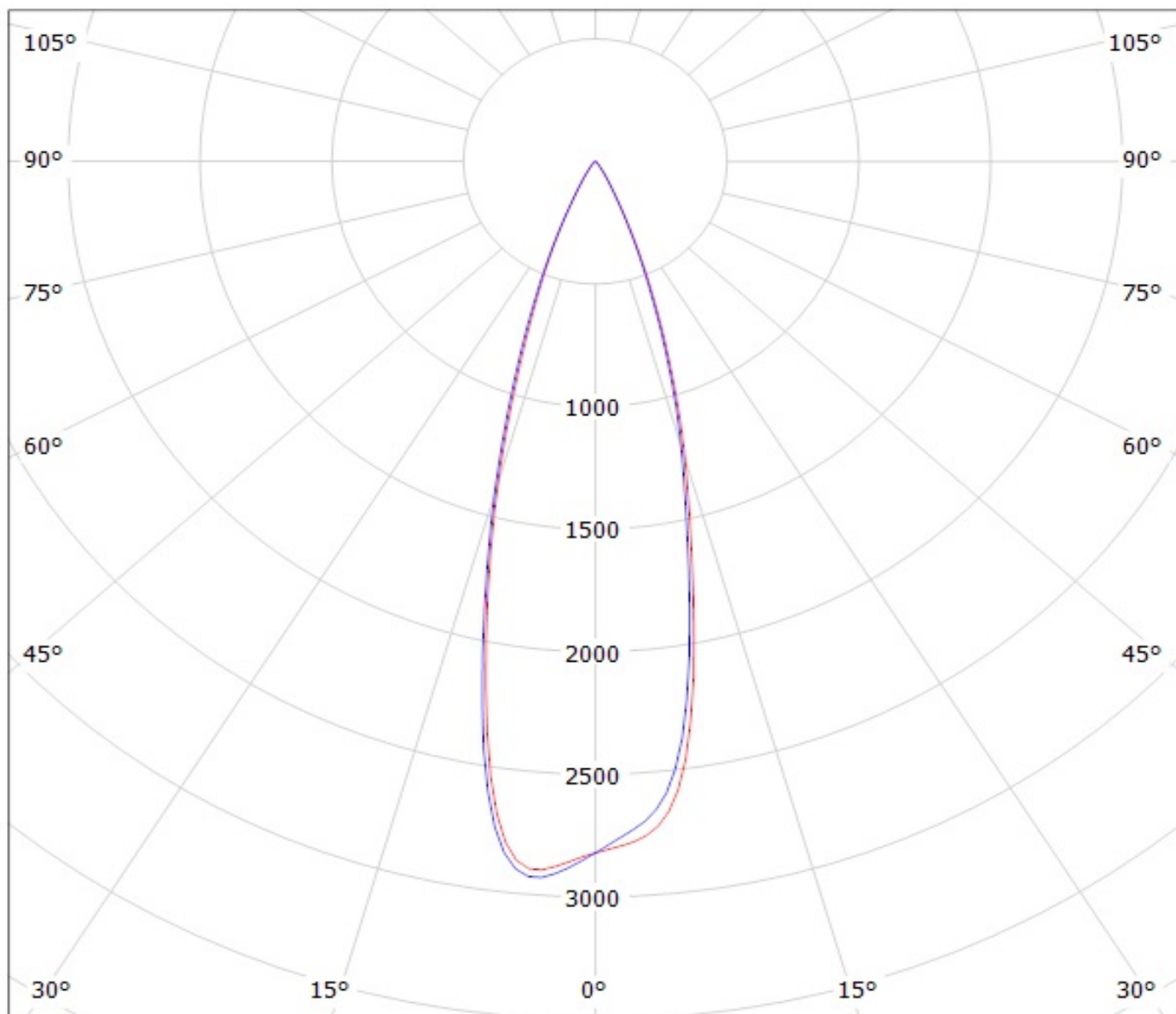

cd/klm

— C0 - C180

— C90 - C270

$\eta = 91\%$

Luminaire: Ledil CA14461\_VERONICA-SQ-M (XP-L2)

Lamps: 1 x Cree\_XP-L2 (XPLWT-00-0000-000HU630G)\_115.868lm@250mA\_P=0.717875W\_I=0.25A

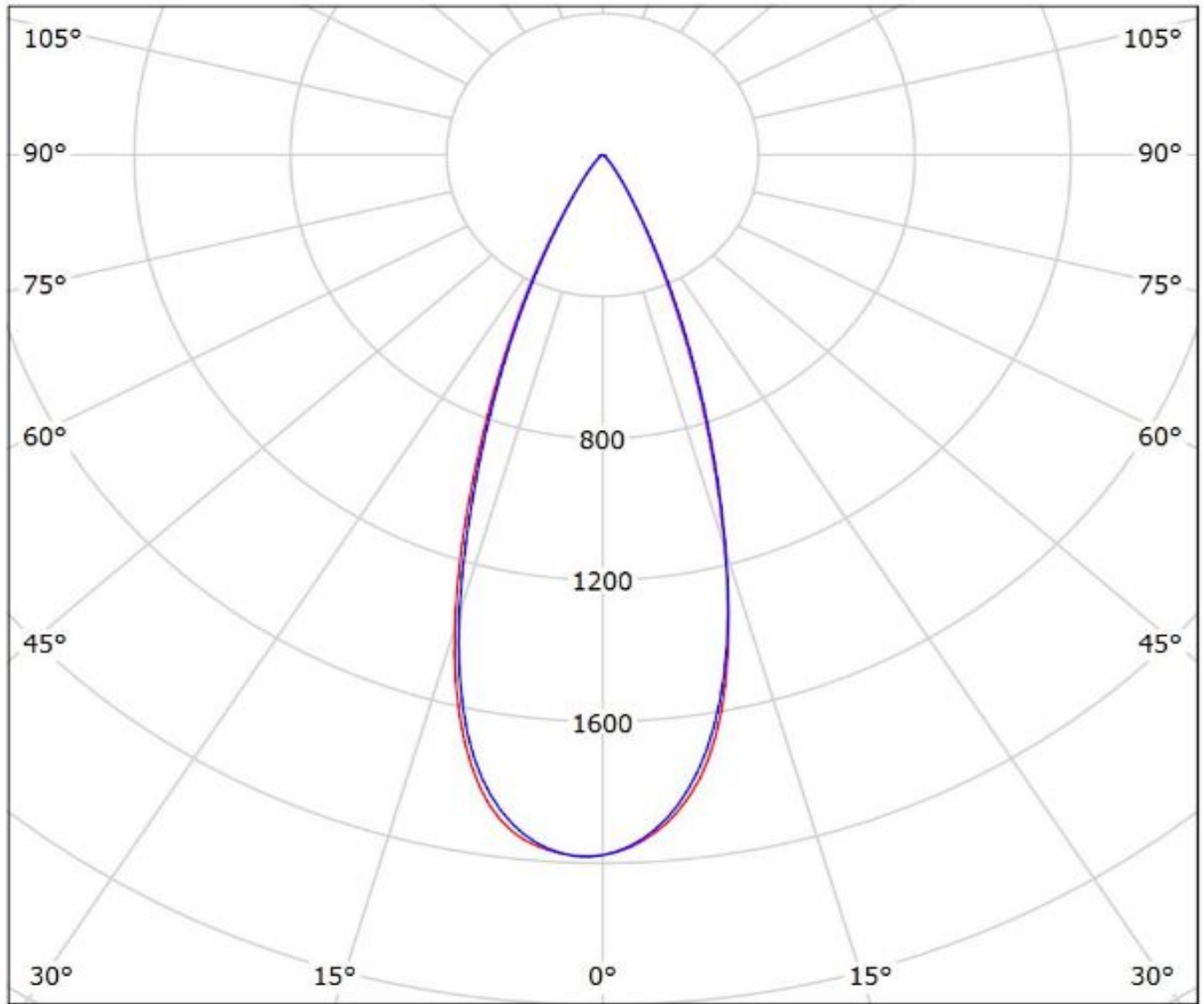

cd/klm

— C0 - C180

— C90 - C270

$\eta = 87\%$

Luminaire: LEDiL Oy CA14461\_VERONICA-SQ-M\_(H35C1)

Lamps: 1 x LG\_H35C1\_(PKG5700K)\_116.036lm@250mA\_CCT=6235K\_P=0.757272W\_I=0.2499A

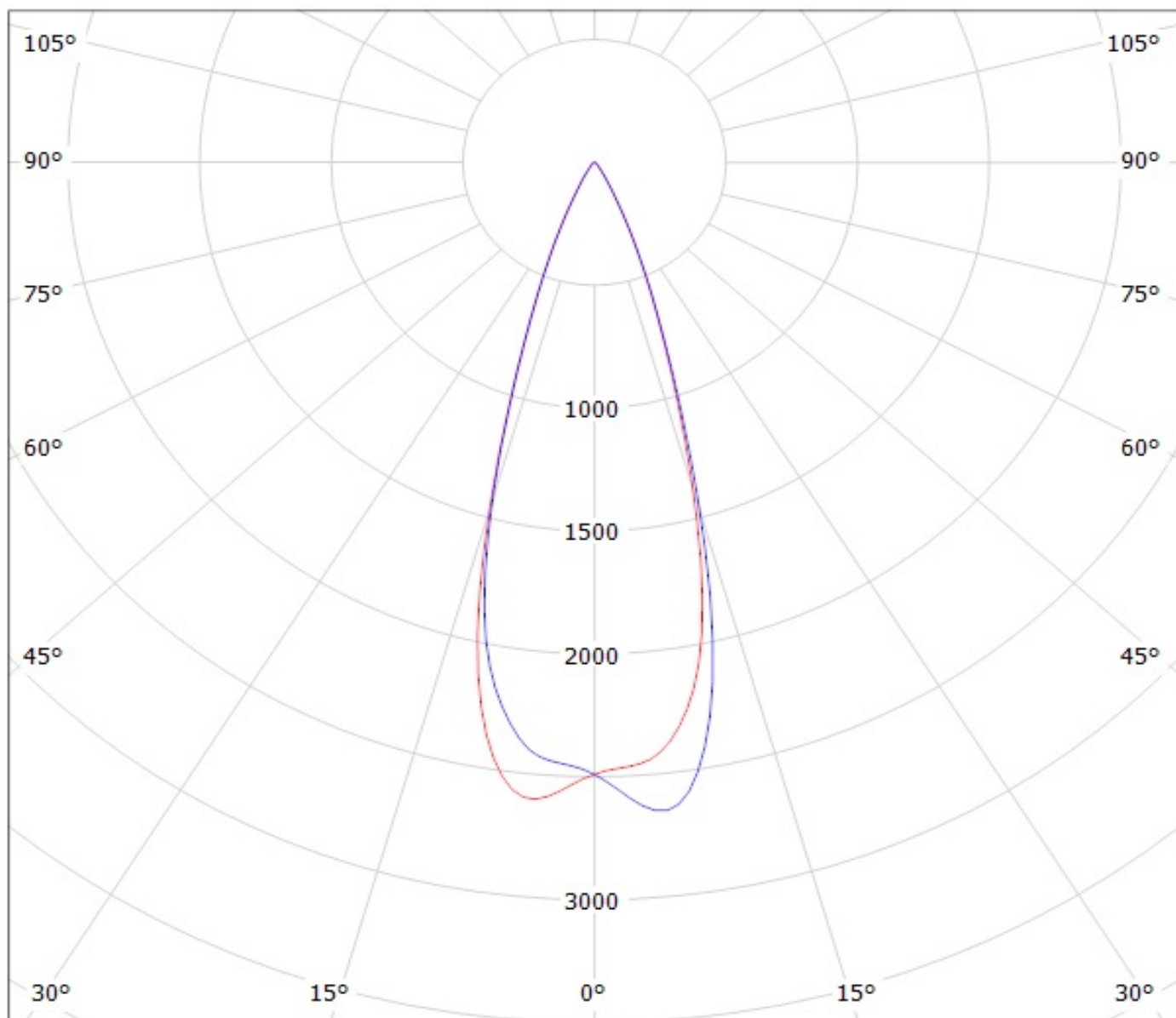

cd/klm

$\eta = 92\%$

— C0 - C180

— C90 - C270

Luminaire: LEDiL Oy CA14461\_VERONICA-SQ-M\_(Luxeon\_MZ)

Lamps: 1 x Philips\_Lumileds\_Luxeon\_MZ\_386.758lm@250mA\_P=2.77489W\_I=0.2499A

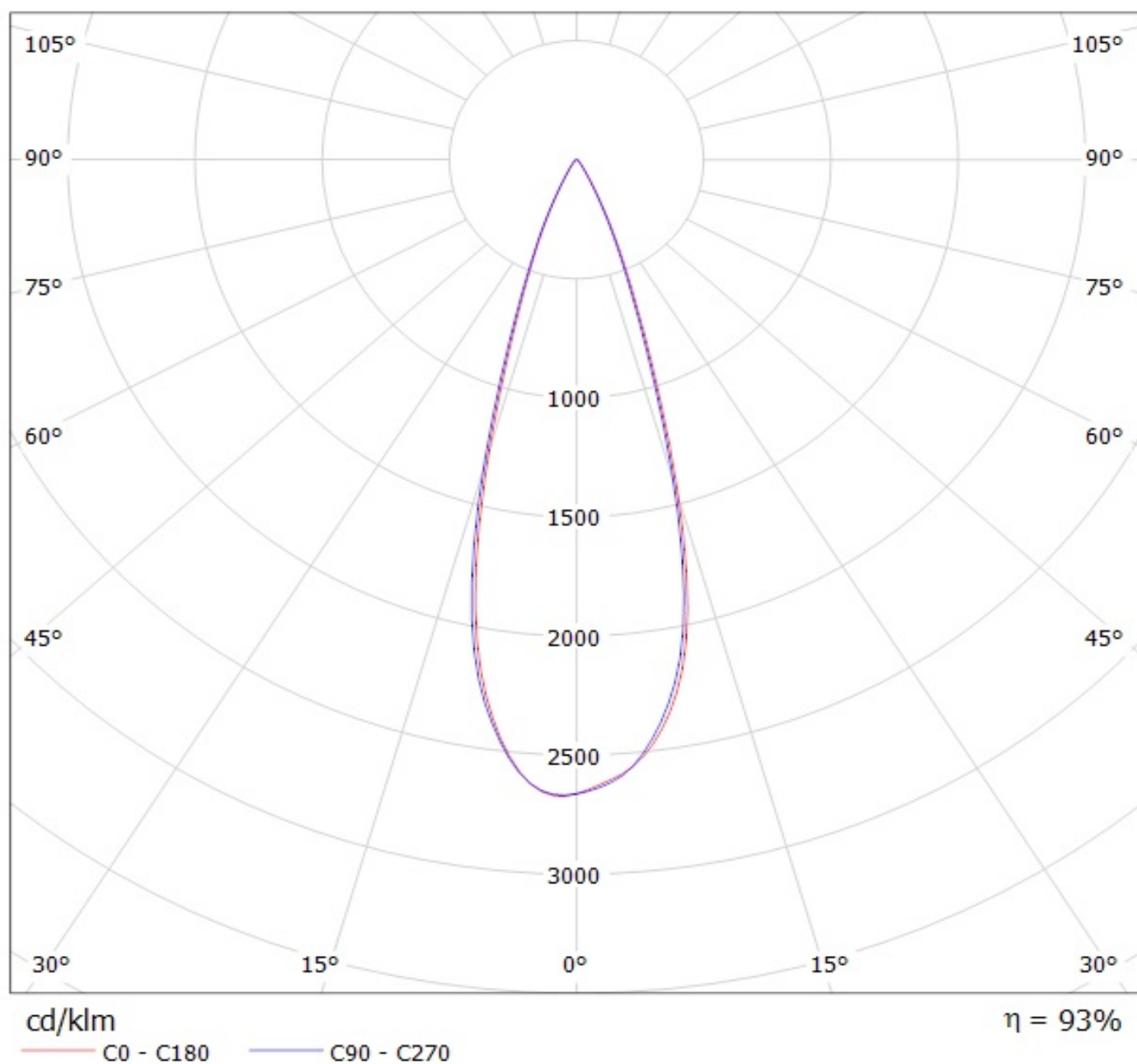

Luminaire: LEDiL Oy CA14461\_VERONICA-SQ-M\_(Luxeon\_R)

Lamps: 1 x Philips\_Lumileds\_Luxeon\_R\_(LXA7-PW30)\_74.1293lm@250mA\_CCT=3049K\_P=0.727484W\_I=0.2499A

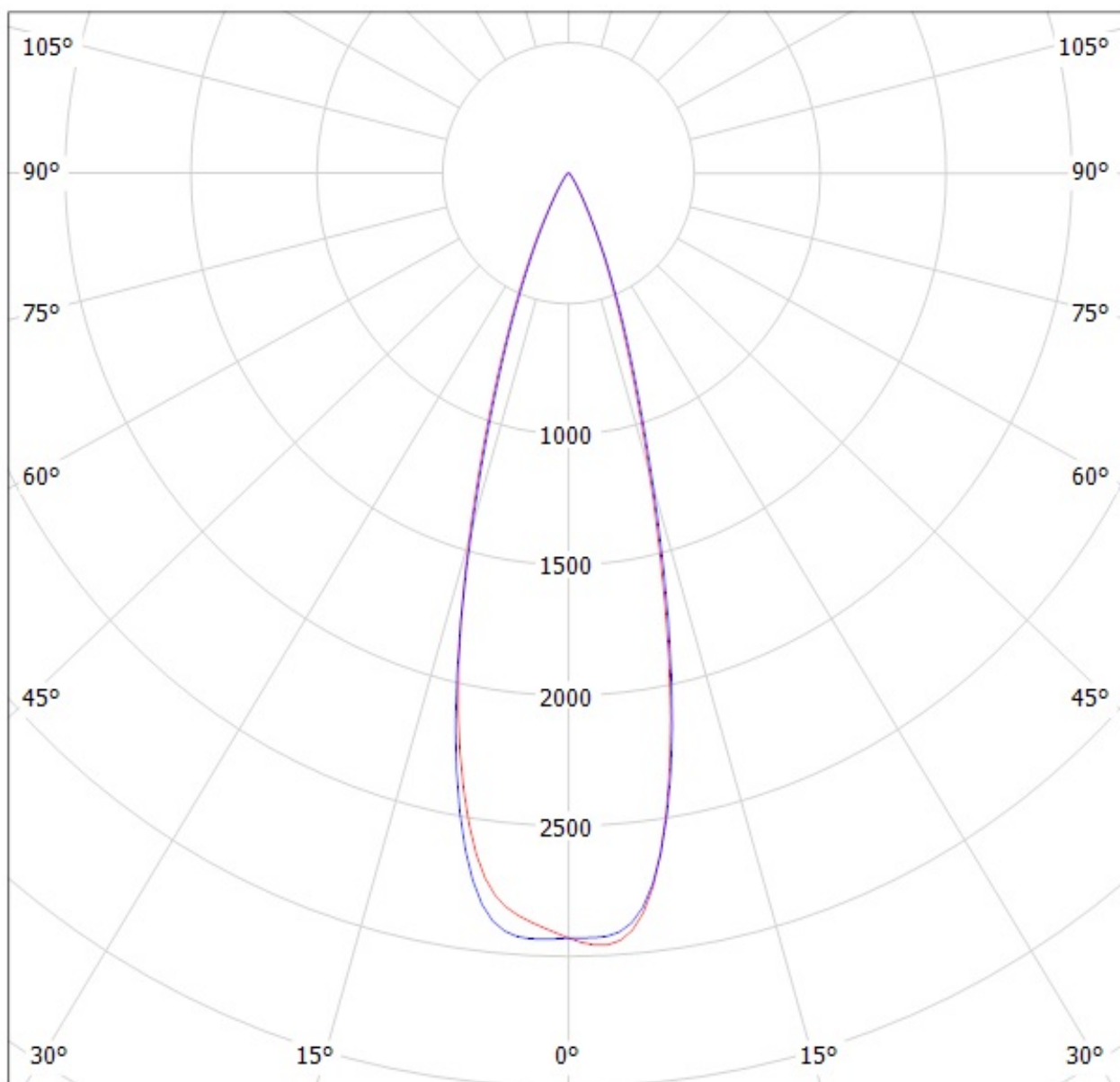

cd/klm

$\eta = 91\%$

— C0 - C180    — C90 - C270



Luminaire: LEDiL Oy CA14461\_VERONICA-SQ-M\_(Luxeon\_Rebel)

Lamps: 1 x Philips\_Lumileds\_Luxeon\_Rebel\_(LXM8-PW30)\_61.1293lm@250mA\_P=0.728758W\_I=0.2499A

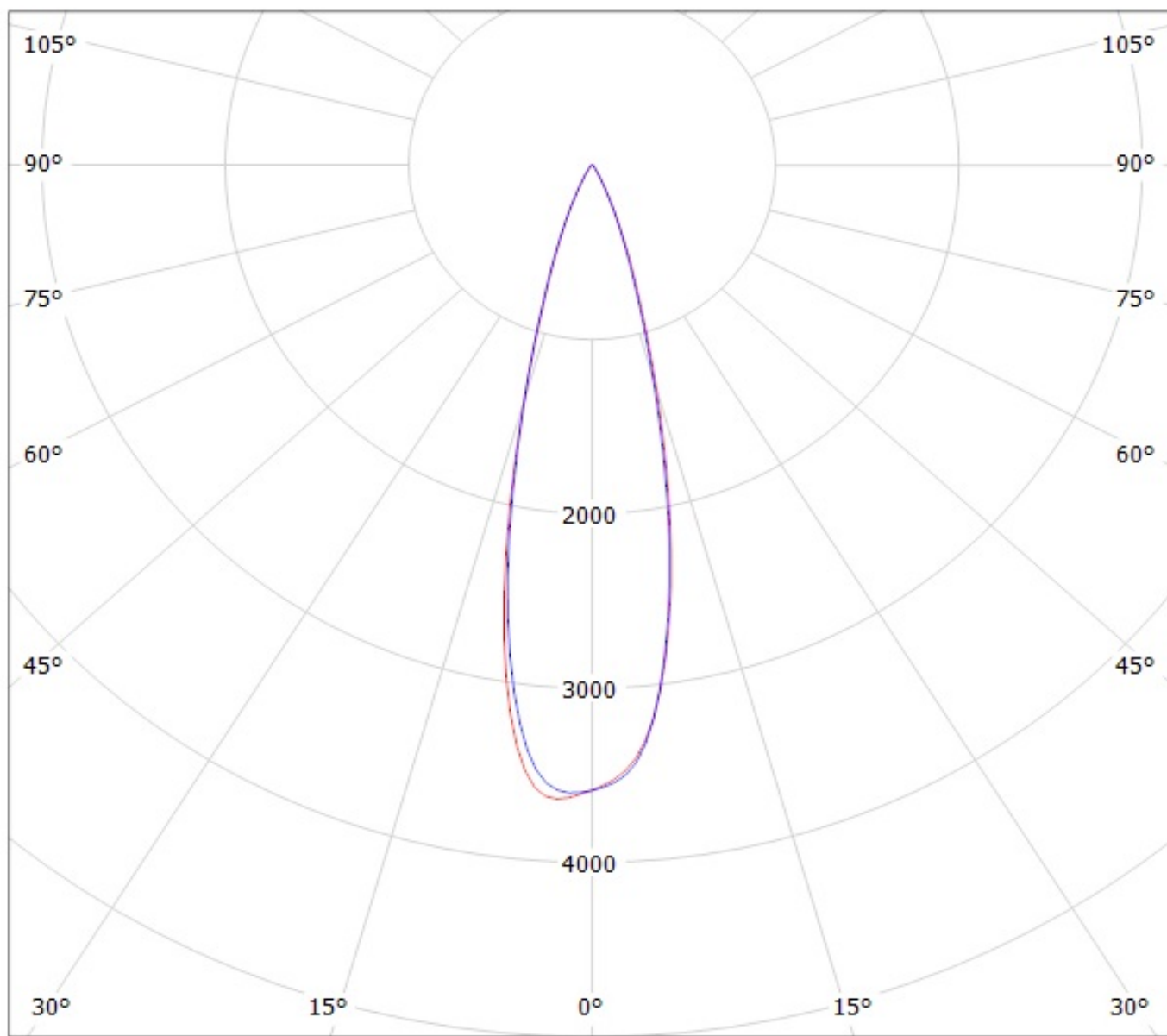

cd/klm

— C0 - C180

— C90 - C270

$\eta = 92\%$

Luminaire: LEDiL Oy CA14461\_VERONICA-SQ-M\_(Luxeon\_T)

Lamps: 1 x Philips\_Lumileds\_Luxeon\_T\_(LXH8-FW30-3)\_72.2743lm@250mA\_P=0.734231W\_I=0.2499A

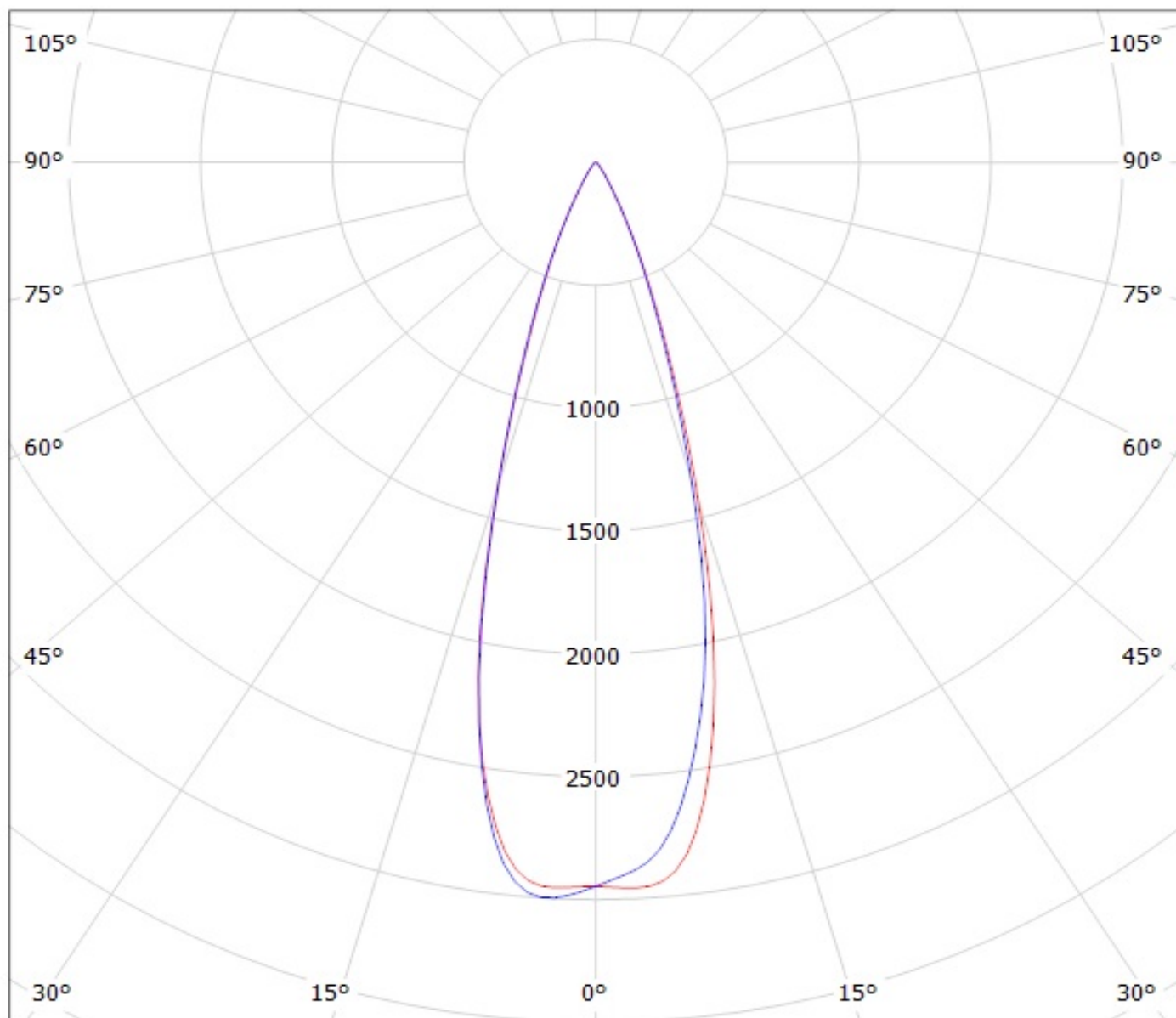

cd/klm

$\eta = 93\%$

— C0 - C180

— C90 - C270



Luminaire: LEDiL Oy CA14461\_VERONICA-SQ-M\_(Luxeon\_TX)

Lamps: 1 x Philips\_Lumileds\_Luxeon\_TX\_(L1T2-3585)\_80.8039lm@250mA\_CCT=3554K\_P=0.740679W\_I=0.2499A

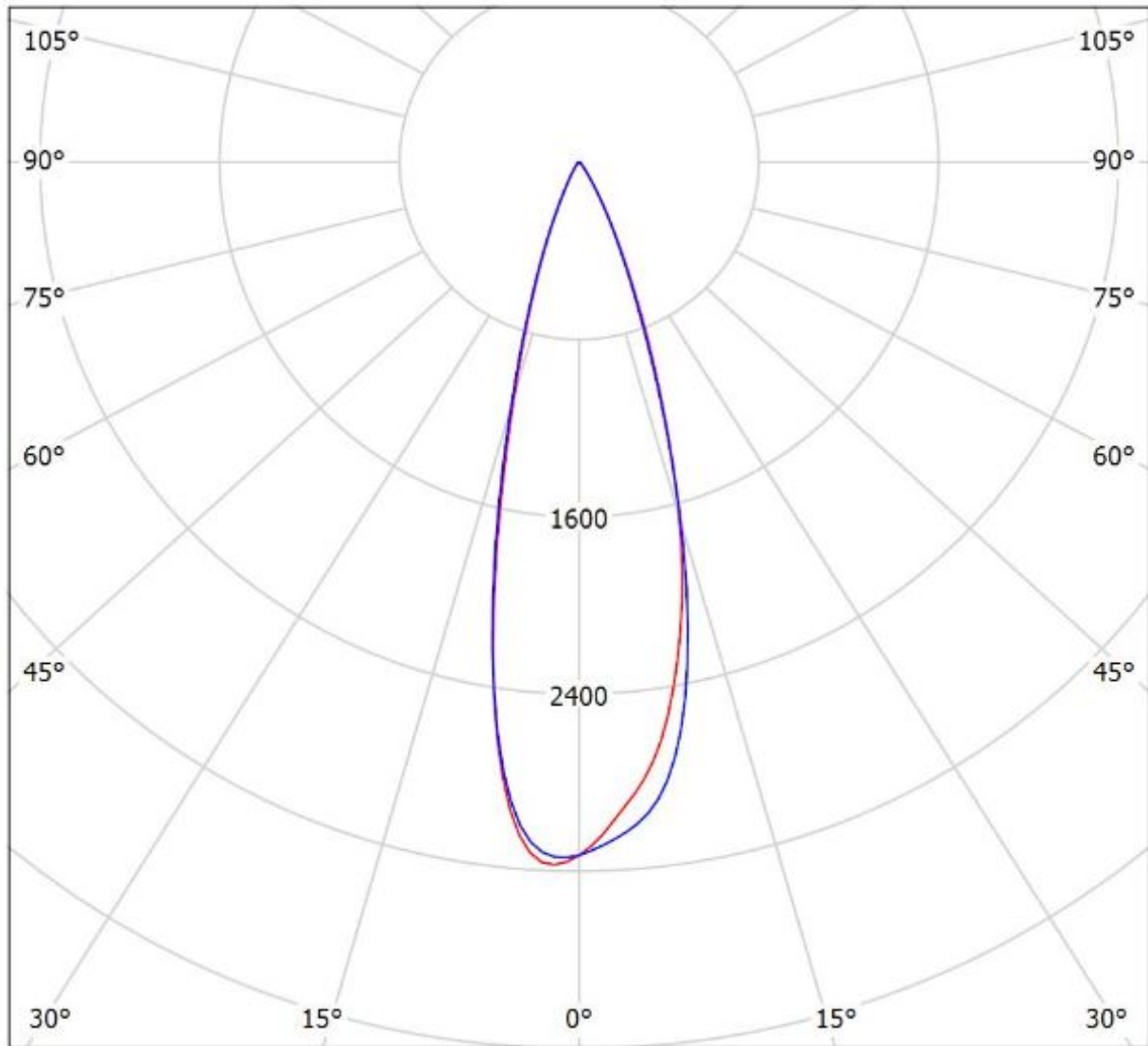

cd/klm

— C0 - C180 — C90 - C270

$\eta = 92\%$

Luminaire: LEDiL Oy CA14461\_VERONICA-SQ-M\_(Luxeon\_Rebel\_ES)

Lamps: 1 x Philips\_Lumileds\_Luxeon\_Rebel\_ES\_(LXML-PWC2)\_89.4472lm@250mA\_P=0.746101W\_I=0.2499A

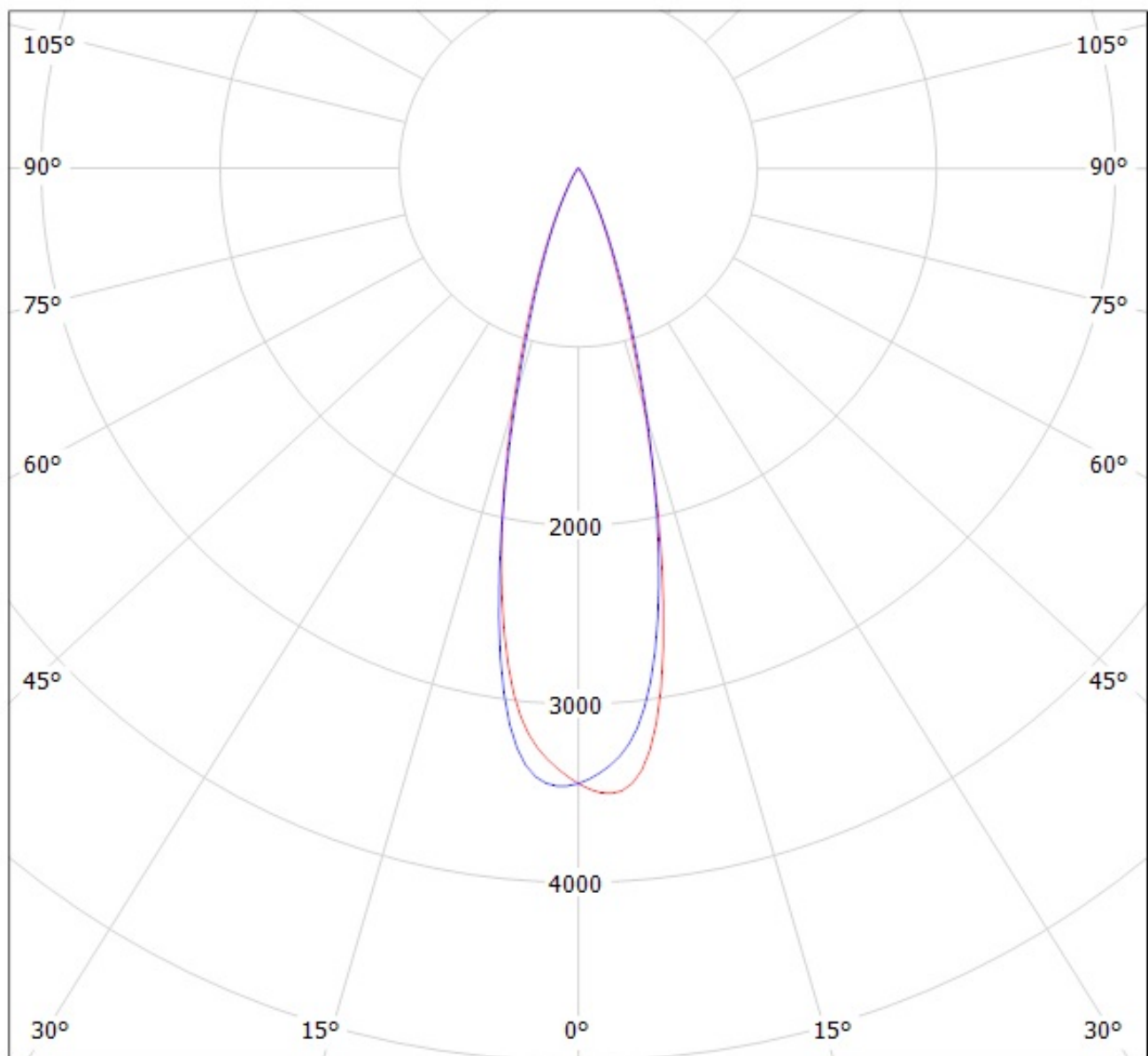

cd/klm

— C0 - C180

— C90 - C270

$\eta = 91\%$

Luminaire: LEDiL Oy CA14461\_VERONICA-SQ-M\_(Luxeon\_A)

Lamps: 1 x Philips\_Lumileds\_Luxeon\_A\_(LXH8-PW30)\_65.8365lm@250mA\_P=0.727284W\_I=0.2499A

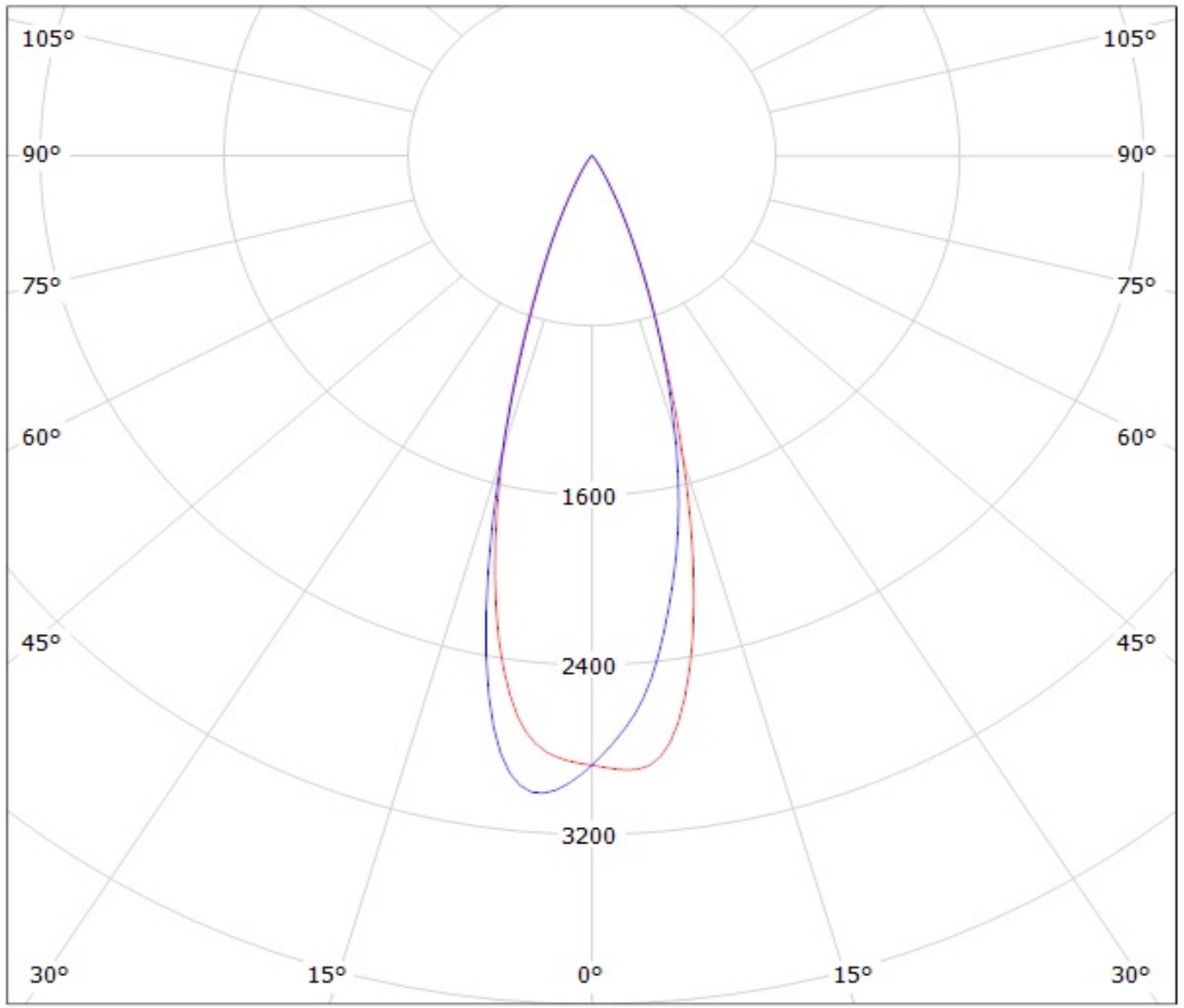

cd/klm

— C0 - C180    — C90 - C270

$\eta = 91\%$

Luminaire: LEDiL Oy CA14461\_VERONICA-SQ-M\_(Nichia\_NVsxx19B)

Lamps: 1 x Nichia\_NVsxx19B\_105.826lm@250mA\_P=0.731182W\_I=250mA

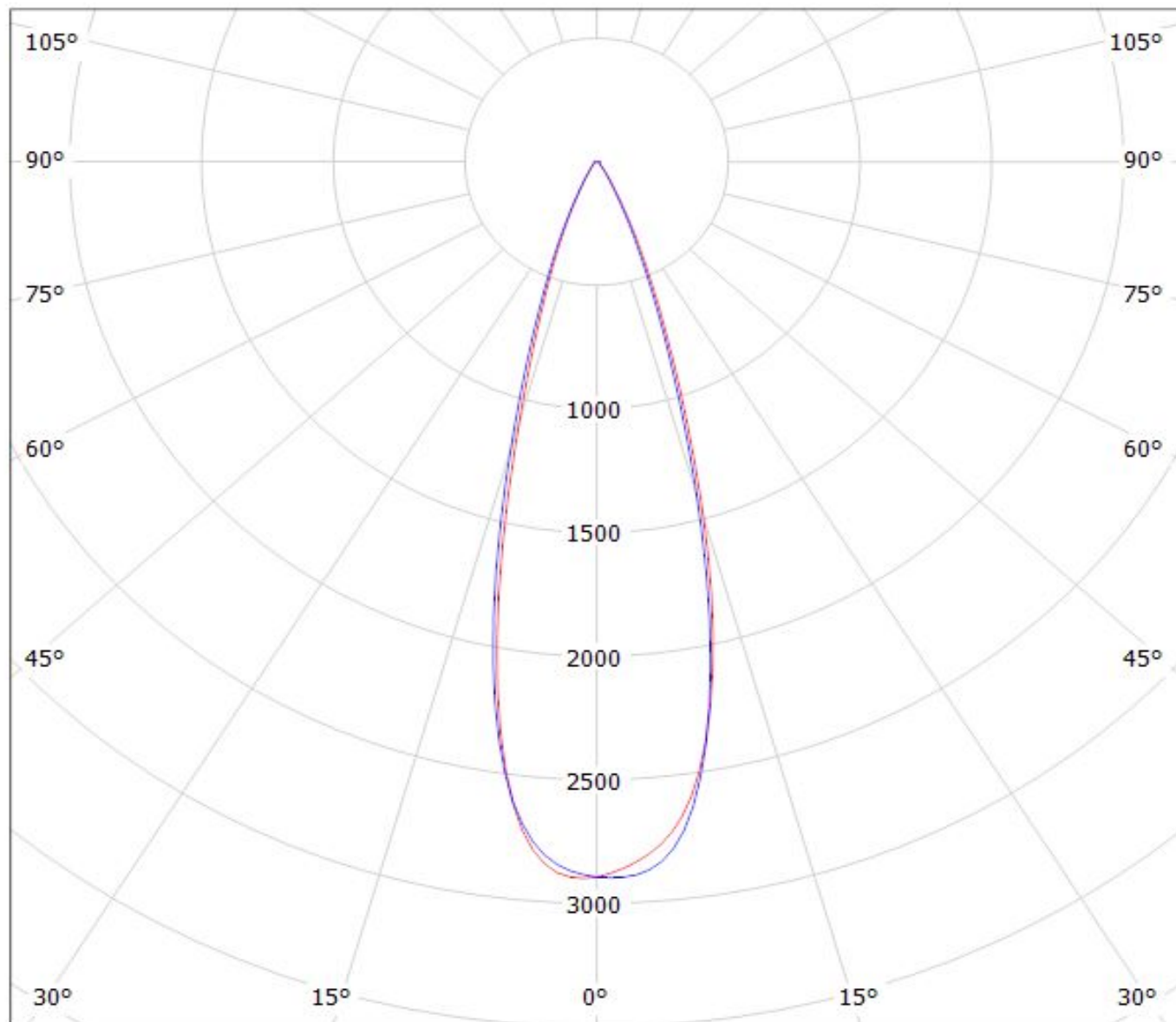

cd/klm

— C0 - C180

— C90 - C270

$\eta = 91\%$

Luminaire: LEDiL Oy CA14461\_VERONICA-SQ-M\_(Nichia\_NCSxx19B)

Lamps: 1 x Nichia\_NCSxx19B\_90.3281lm@250mA\_P=0.795931W\_I=250mA

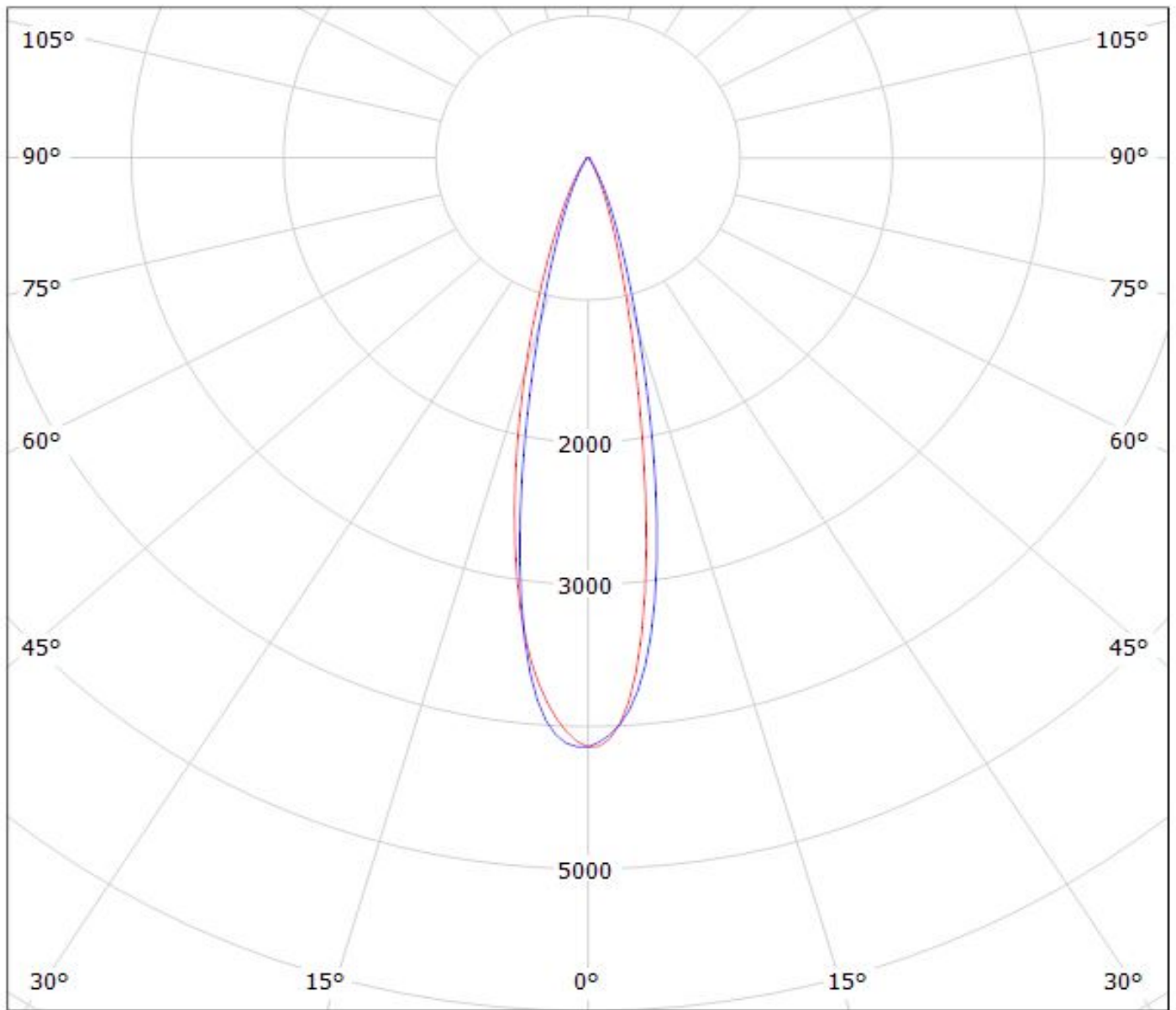

cd/klm

$\eta = 92\%$

— C0 - C180

— C90 - C270

Luminaire: LEDiL Oy CA14442\_VERONICA-SQ-W\_(NWSL229AE)

Lamps: 1 x Nichia\_NWSL229AE\_120.54lm@250mA\_P=0.7128W\_I=0.250A

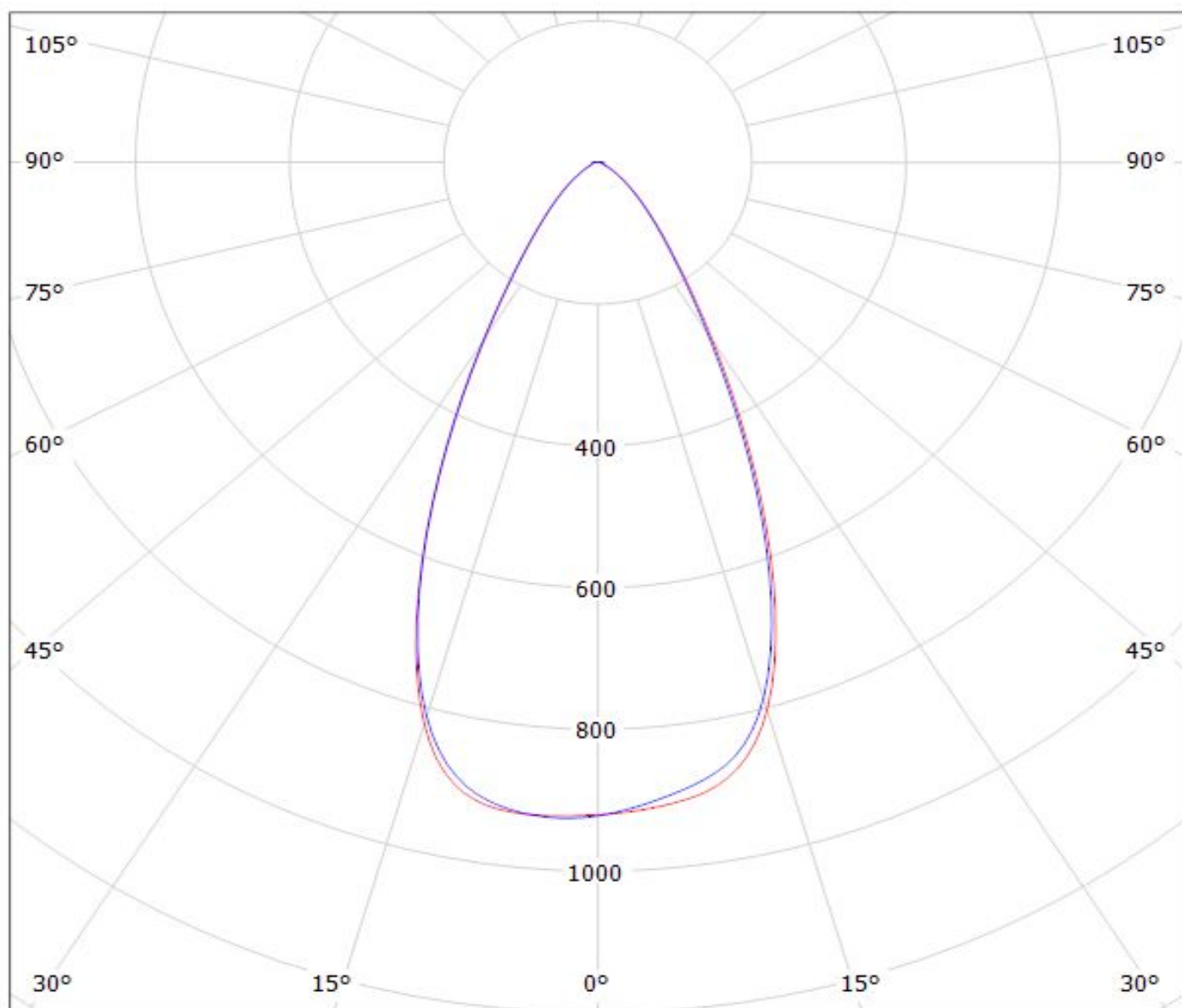

cd/klm

— C0 - C180

— C90 - C270

$\eta = 78\%$



Luminaire: LEDiL Oy CA14461\_VERONICA-SQ-M\_(Oslon\_Square\_PC)

Lamps: 1 x Osram\_Oslon\_Square-PC\_(LCW\_CQAR.PL-MSMV-5H71-1)\_99.714lm@250mA\_P=0.770717W\_I=0.2499A

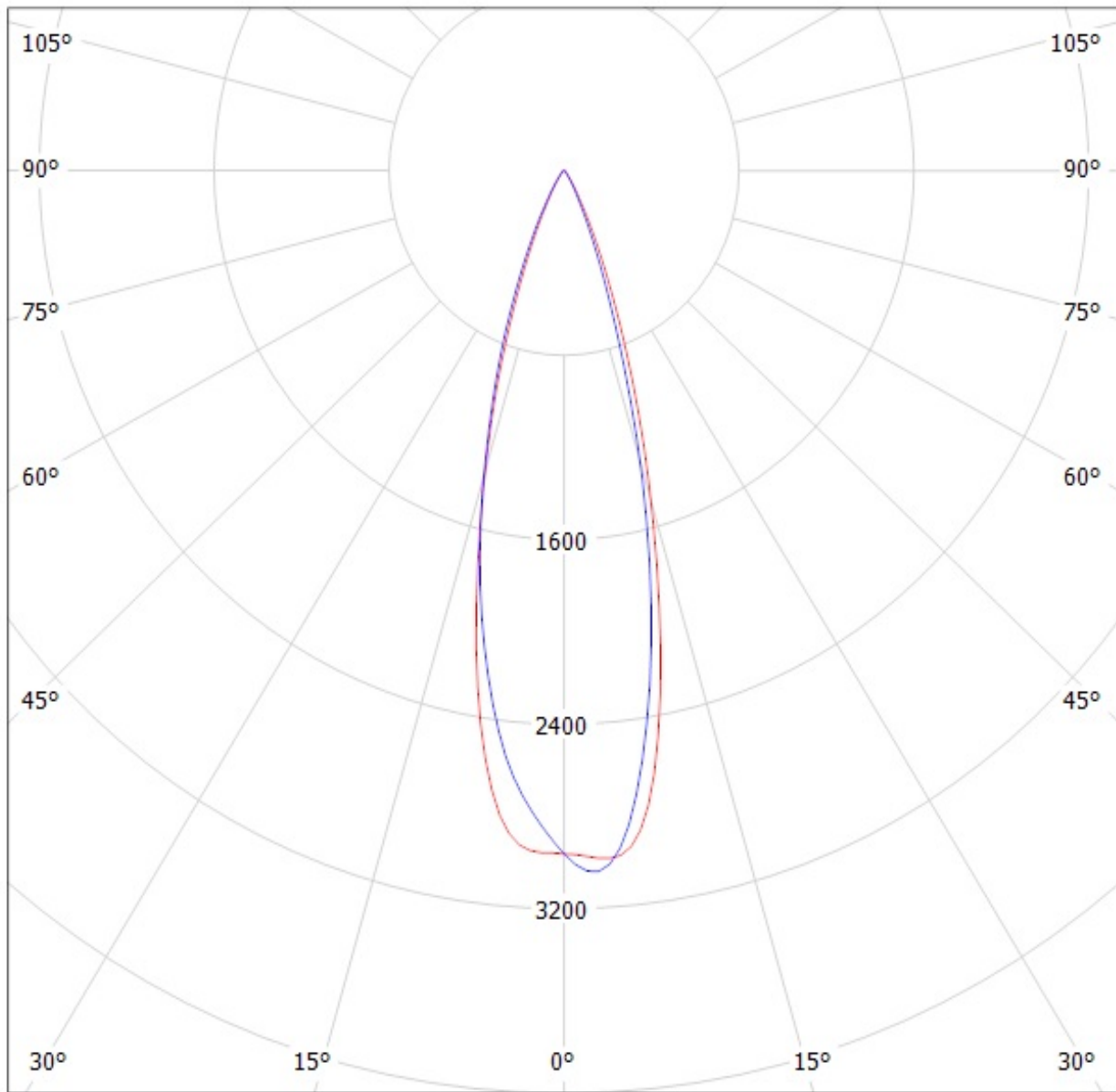

cd/klm

$\eta = 91\%$

— C0 - C180

— C90 - C270

Luminaire: LEDiL Oy CA14461\_VERONICA-SQ-M\_(Oslon\_Square\_EC)

Lamps: 1 x Osram\_Oslon\_Square\_EC\_(GW\_CSSRM1.EC)\_85.3477lm@250mA\_P=0.738904W\_I=0.2499A

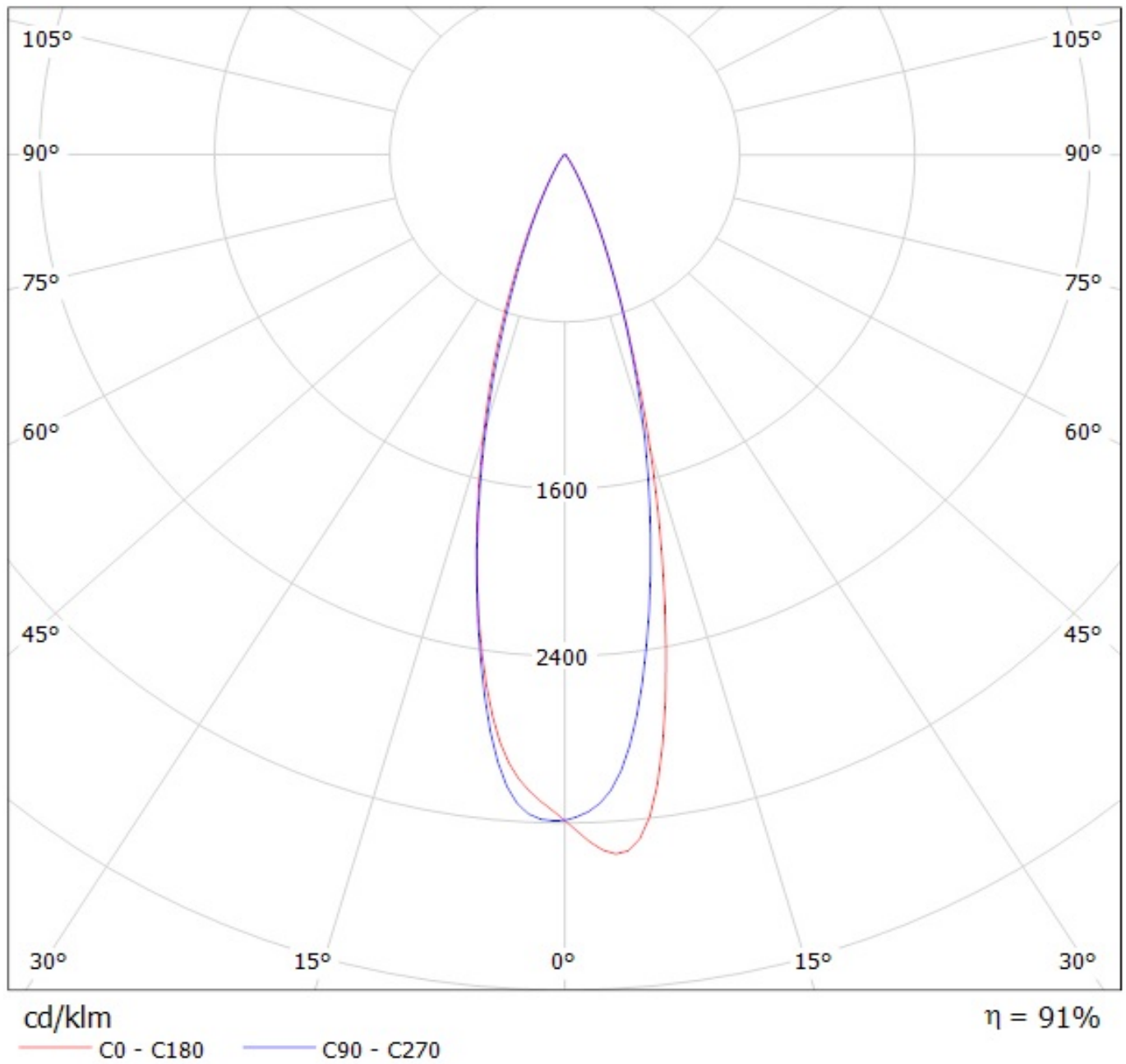



Luminaire: LEDiL Oy CA14461\_VERONICA-SQ-M\_(Z8Y22plus)

Lamps: 1 x Seoul\_Z8Y22plus\_(W6E2G)\_125.652lm@250mA\_P=0.69312W\_I=0.250A

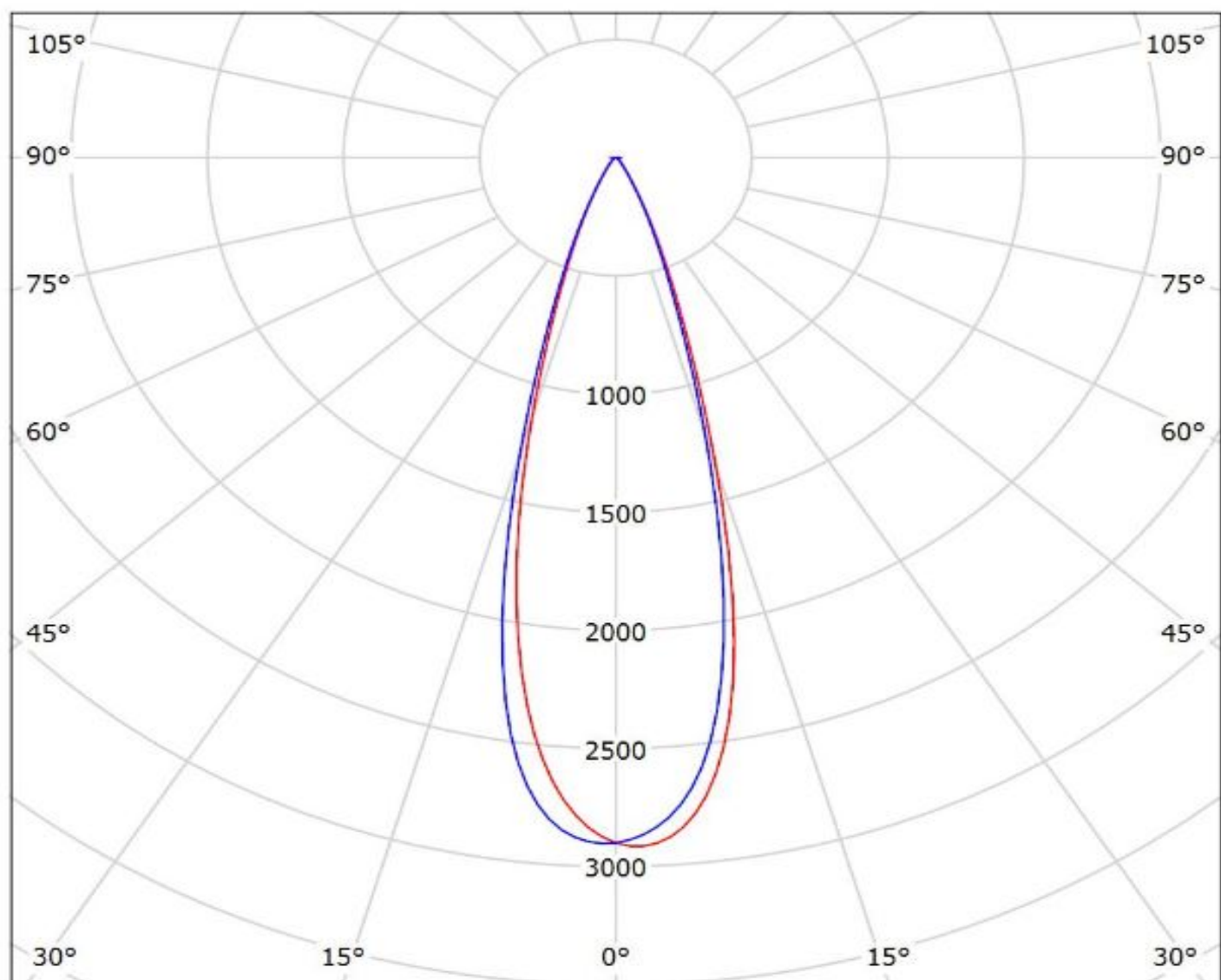

cd/klm

— C0 - C180 — C90 - C270

$\eta = 88\%$

**NOTE: The typical divergence will be changed by different color, chip size and chip position tolerance. The typical total divergence is the full angle measured where the luminous intensity is half of the peak value.**