

RECOMMENDED PCB LAYOUT

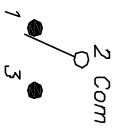

CIRCUIT: SPDT

SWITCH FUNCTION		
POS. 1	POS. 2	POS. 3
DN	NONE	DN
2-3	DPEN	2-1

NOTES:

1. ALL DIMENSIONS IN MM [INCH]
2. GENERAL TOLERANCE: X.XX=±0.4 X.XXX=±0.25
3. TERMINAL NUMBERS FOR REF ONLY
4. RATING: 0.4VA @20V ACOR DC max.
5. FIXED TERM. & MOVING CONTACT:
Copper Alloy w/Gold plate over Nickel plate.
6. ELECTRIC LIFE: 40,000 make-and-break cycles at full load.
7. INSULATION RESISTANCE: 1,000 Mega-ohm min.
8. DIELECTRIC STRENGTH: 1,000 V RMS @sea level.
9. OPERATING TEMP.: -30°C to 85°C

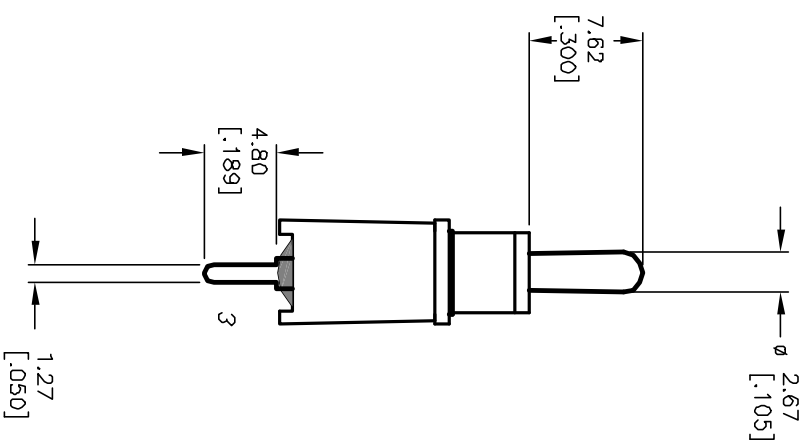
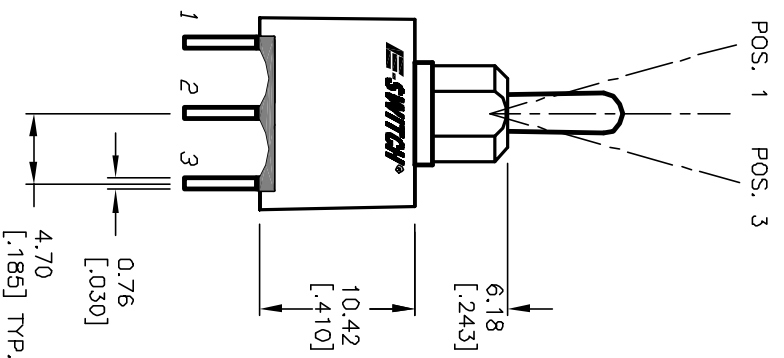
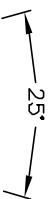
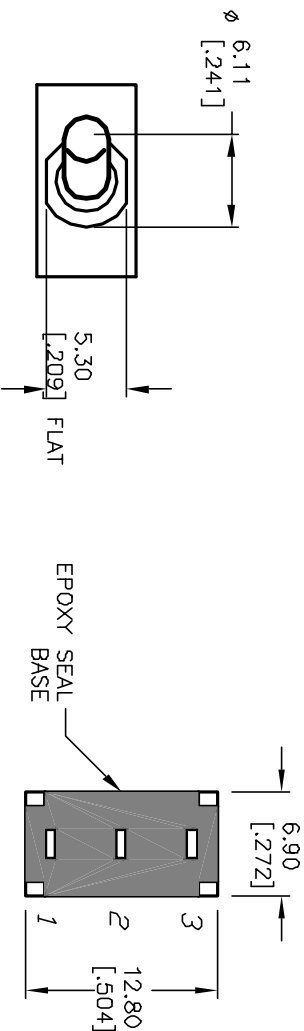

E-SWITCH®

TITLE 100A WSP-1 T2 B4 M2 R E (GOLD CONTACTS)

SCALE 2:1 DATE 9/20/02 DR CB DWG T101032 REV A

REV. A	12363	RELEASED	9/20/02	CB
REV. ECN NO.		DESCRIPTION	DATE	CHK'D

THE INFORMATION CONTAINED IN THIS DOCUMENT IS PREPARED BY E-SWITCH AND IS NOT TO BE COPIED OR TRANSMITTED