

LOC	DIST	REV	DATE	BY	APPV
CM	52	P	3-6-98	TB	RS

- REVISIONS
- ACCEPTS TERMINALS 61347-1 AND 350490-1.
 - RELAYS MAY BE MOUNTED ON 45.72 X 40.39 CENTERS.

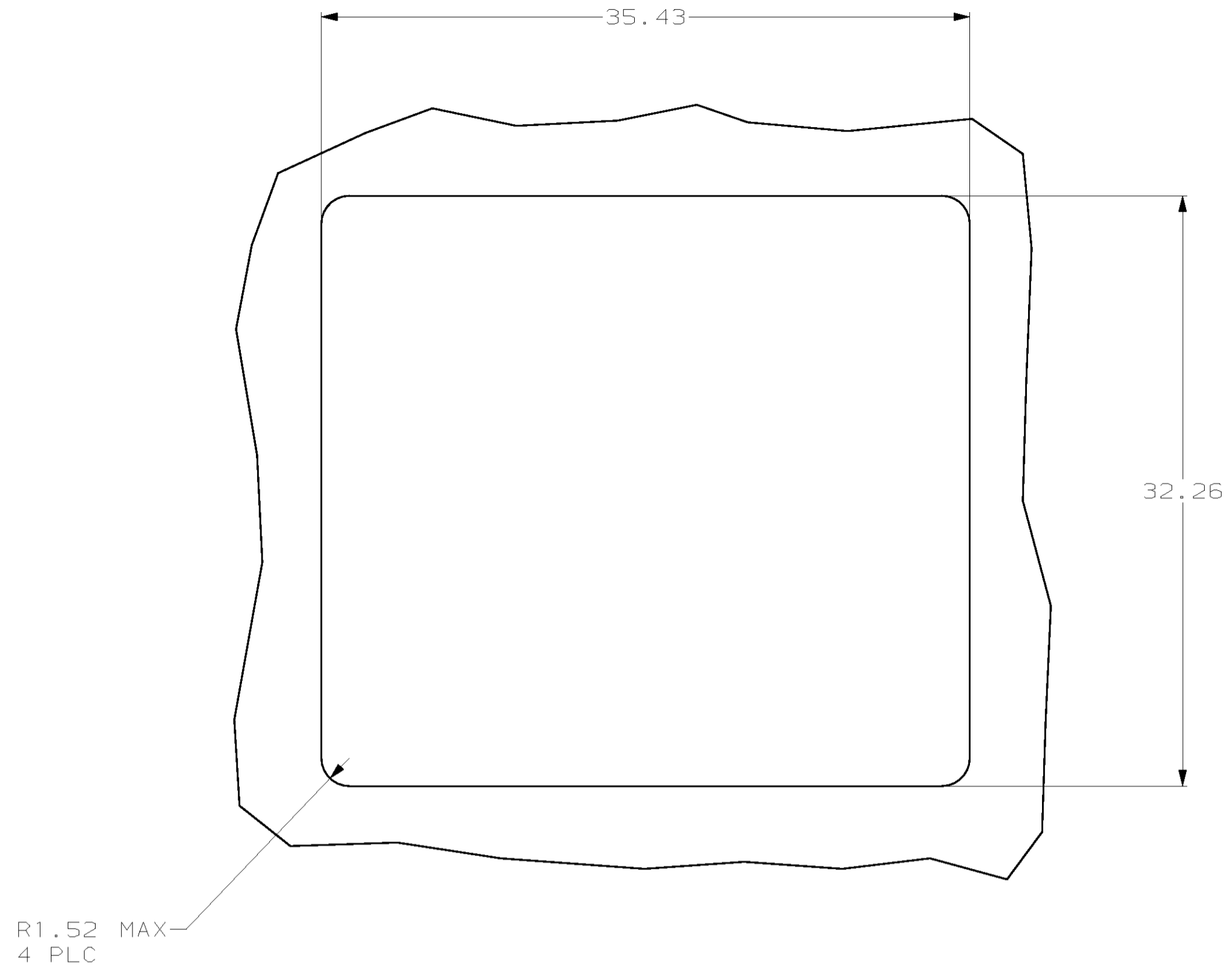

RECOMMENDED CUT OUT FOR 2.54 MAX THICK PANEL

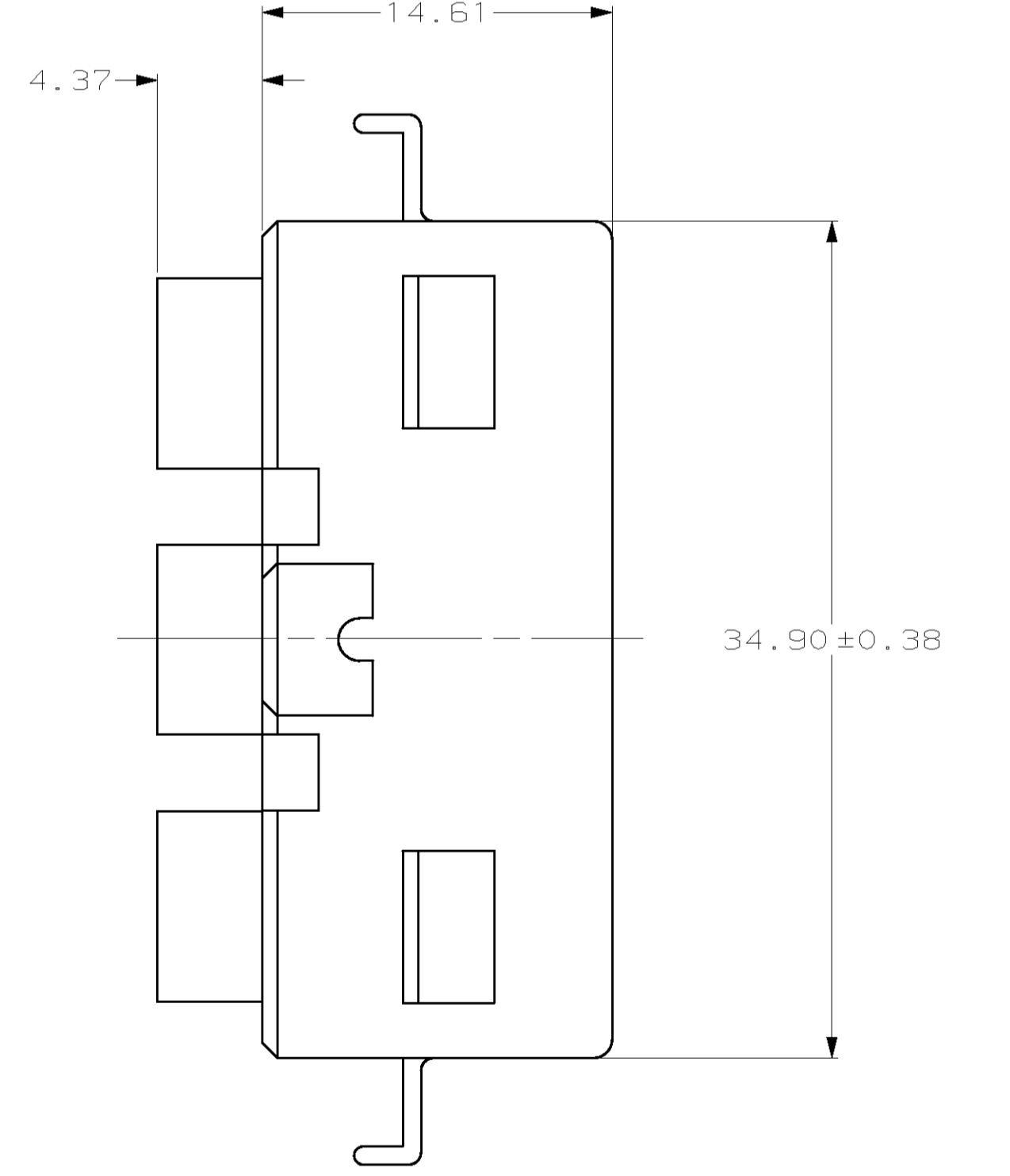
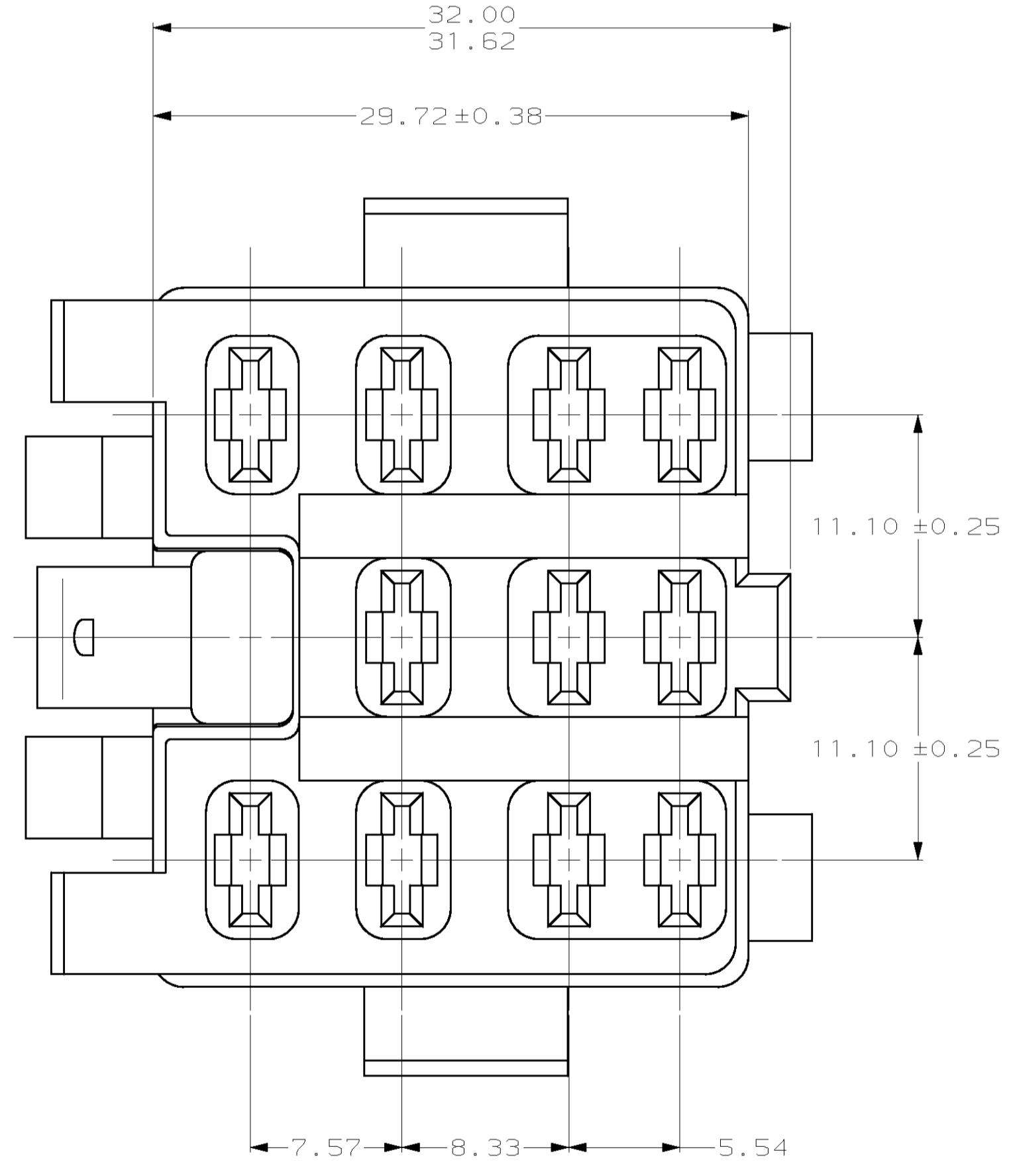
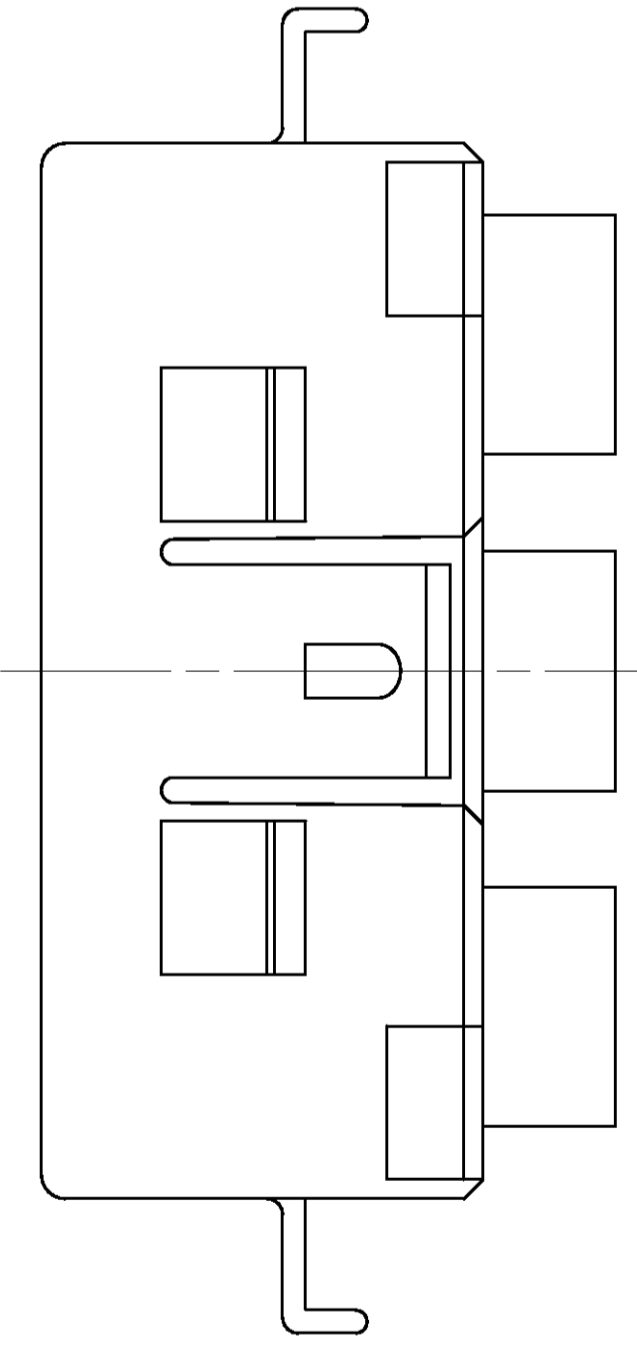

MM	IN	MM	IN	MM	IN	MM	IN
2.54	.100	11.10	.437	32.26	1.270	-	-
1.52	.060	8.33	.328	32.00	1.260	45.72	1.800
0.38	.015	7.57	.298	31.62	1.245	40.39	1.590
0.25	.010	5.54	.218	29.72	1.170	35.43	1.395
0.13	.005	4.37	.172	14.61	.575	34.90	1.374

CONVERSION TABLE

METRIC

THIS DRAWING IS A CONTROLLED DOCUMENT.

DATE: 3-6-98	CHK: T. BECK	APPV: R. SWING
DATE: 3-6-98	CHK: R. SWING	APPV: G. JONES

AMP Incorporated
 Harrisburg, PA 17105-3608

HOUSING, 11 CIRCUIT, KU TYPE,
 RELAY CONNECTOR

SIZE: A1
 SCALE: 4:1
 SHEET: 1 OF 1
 REV: P

1-380993-0
 PART NUMBER