

Customer Information Sheet

DRAWING No.: SOX-46

SHEET 2 OF 2

IF IN DOUBT - ASK

Ⓒ

NOT TO SCALE

THIRD ANGLE PROJECTION

ALL DIMENSIONS IN mm

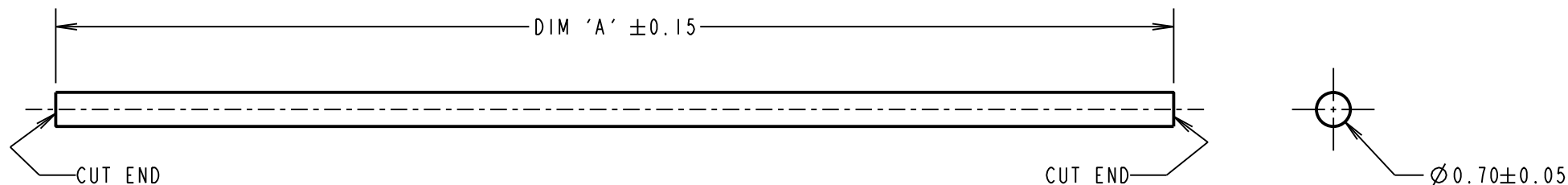

NOTES:

1. THIS PRODUCT IS RECOMMENDED FOR USE WITH S8071-46R AND S8081-46R SMT CLIPS.
3. MAXIMUM BURR ON CUTTING AREA = 0.05mm.
4. ALL PRODUCT IS RoHS AND REACH COMPLIANT.
5. PACKAGING = 100 COMPONENTS PER BAG.

SPECIFICATIONS:

MATERIAL = PHOSPHOR BRONZE
 FINISH = 2-4 μ TIN OVER 1-2 μ NICKEL
 ELECTRICAL:
 CURRENT RATING = 1.5A
 VOLTAGE RATING = 250V AC/DC
 CONTACT RESISTANCE = 20m Ω MAX

ORDER CODE:

SOX-46

PIN LENGTH:

7 = 23.00
 8 = 15.00

FINISH:

46 = 2-4 μ TIN OVER
 1-2 μ NICKEL

PART No.	DIM 'A'
S07-46	23.00
S08-46	15.00

SB	I	DATE	C/NOTE
		17.06.15	-----
NAME		ISS.	C/NOTE
APPROVED:		S.BENNETT	
CHECKED:		M.PLESTED	
DRAWN:		S.BENNETT	
CUSTOMER REF.:			
ASSEMBLY DRG:			

HARWIN

www.harwin.com
 technical@harwin.com

THIS DRAWING AND ANY INFORMATION OR DESCRIPTIVE MATTER SET OUT HEREON ARE CONFIDENTIAL AND COPYRIGHT PROPERTY OF THE HARWIN GROUP AND MUST NOT BE DISCLOSED, LOANED, COPIED OR USED FOR MANUFACTURING, TENDERING OR FOR ANY OTHER PURPOSE WITHOUT THEIR WRITTEN PERMISSION.

TOLERANCES

X. = ±1mm
 X.X = ±0.50mm
 X.XX = ±0.10mm
 X.XXX = ±0.01mm

ANGLES = ±5°
 UNLESS STATED

MATERIAL:

SEE ABOVE

FINISH:

SEE ABOVE

S/AREA:

mm²

TITLE:

BRIDGE PIN

DRAWING NUMBER:

SOX-46

SHT
 2 OF 2